



Technical Standards and Safety Authority
www.tssa.org

14th Floor - Centre Tower
3300 Bloor Street West
Toronto Ontario M8X 2X4
Fax: 416.231.4903
Customer Service: 1.877.682.8772

Level 1 Risk and Safety Management Plan (RSMP)
Technical Standards and Safety Act
Propane Storage and Handling Regulation

This Level 1 RSMP applies to:

- a facility with a total propane storage capacity of 5,000 USWG or less; or
- a facility with a fixed propane storage capacity of exactly 5,000 USWG and no more than 500 USWG of portable propane storage capacity on site.

June 1

Failure to fully complete this form may result in rejection.
Making a false statement may result in a fine or prosecution
under the *Technical Standards and Safety Act*

Licence Number 0076512029-c

Check applicable type of propane operations.

Cylinder Motor Fill Filling Plant Card/Keylock

Submit along with this completed application a Facility Site Plan and a Map of the Surrounding Area.

For Office Use Only



SECTION A: GENERAL INFORMATION

The Undersigned applies to TSSA for a review for an RSMP under Ontario's *Technical Standards and Safety Act*, Propane Storage and Handling Regulation.

Company Name Speedy Auto Repair Ltd Ontario Corporation No., if applicable _____

A Operator Name (if different from above)
Nick Bruneau

Telephone No. (705)568-8564 Fax No. (705)568-6656 E-mail nick@rontsnowmobile.com

B Street No. 16 Street Name / 911 Number / Address, if applicable Kirkland Street East

Town / City or Township / County Kirkland Lake Province ON Postal Code P2N 1P3

Mailing address if different from above.

C Street No. _____ Street Name / 911 Number / Address, if applicable _____

Town / City or Township / County _____ Province _____ Postal Code _____

Information on Container Refill Centre or Filling Plant

Location of facility.

D Street No. 16 Street Name / 911 Number / Address, if applicable Kirkland Street East Nearest Major Intersection Kirkland St E. & Station Rd. South

Town / City or Township / County Kirkland Lake Province ON Postal Code P2N 1P3

Name of Licence Holder Nick Bruneau

Name of a Senior Management person as defined in the regulation holding the Record of Training (ROT). Nick Bruneau ROT type PP0-3

Municipality (or municipalities if the facility or its hazard distance touches multiple borders)
Kirkland Lake

Hours of operation. 

This document is valid until the next licence renewal date. You are required by law to notify TSSA of any change of information.

Declaration: I am aware that it is an offence to give false information in this document and I hereby declare that the information I have given here is true and complete.

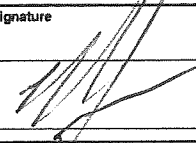
Print name	Signature	Date (dd-mm-yyyy)
Name of Licence Holder <u>Nick Bruneau on behalf of Speedy Auto Repair Ltd</u>		<u>19-05-2011</u>
Name of Senior Management person as defined in the Regulation holding the Record of Training <u>Nick Bruneau</u>		



Technical Standards and Safety Authority
www.tssa.org

14th Floor - Centre Tower
3300 Bloor Street West
Toronto Ontario M8X 2X4
Fax: 416.231.4903
Customer Service: 1.877.682.8772

Level 1 Risk and Safety Management Plan (RSMP)
Technical Standards and Safety Act
Propane Storage and Handling Regulation

SECTION A: GENERAL INFORMATION (cont'd)

Indicate the year the facility was established. Indicate the year of any significant modifications, as defined in s.1, O.Reg 211/01, since establishment.
1986 None

Identify the psig rating and serial number for each fixed propane storage tank on site.

	PSIG	Serial Number
Tank 1:	250 PSIG	5.563197
Tank 2:	_____	_____
Tank 3:	_____	_____

Enter capacity of propane in USWG, fixed, portable, and mobile, and provide detailed inventory that includes the number of tank/vessel for each type (fixed, portable, and mobile) and the capacity of each tank/vessel, on a separate document.

Fixed: 2000 USWG Portable: 660 USWG Mobile: 0

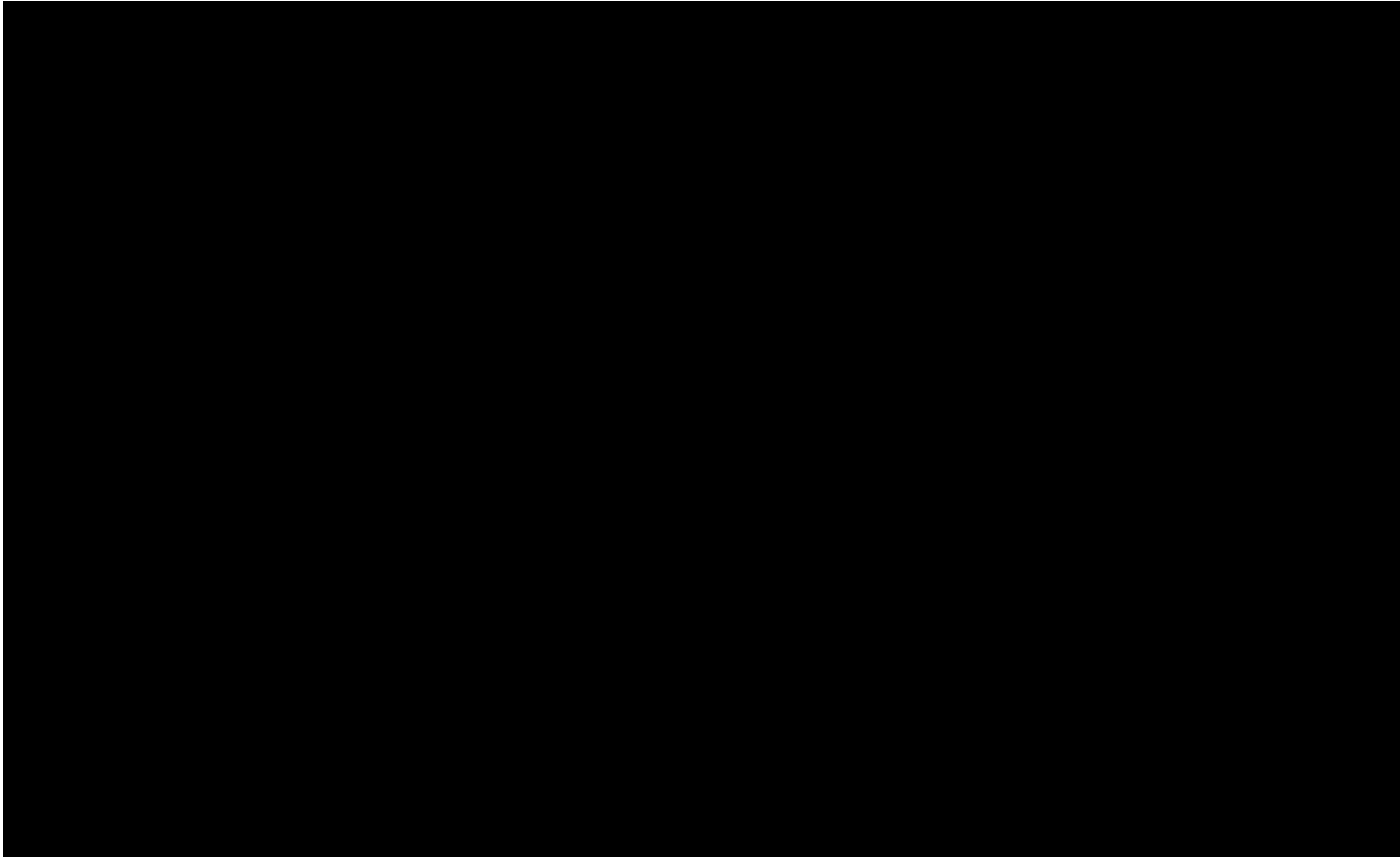

Declaration: I am aware that it is an offence to give false information in this document and I hereby declare that the information I have given here is true and complete.

Name of person completing this form (please print)		Official Title	
Nick Bruneau		Owner	
Signature		Telephone No.	Date (dd-mm-yyyy)
		(705)568-8564	19-05-2011



Technical Standards and Safety Authority
www.tssa.org

14th Floor - Centre Tower
3300 Bloor Street West
Toronto Ontario M8X 2X4
Fax: 416.231.4903
Customer Service: 1.877.682.8772

Level 1 Risk and Safety Management Plan (RSMP)
Technical Standards and Safety Act
Propane Storage and Handling Regulation

SECTION A: GENERAL INFORMATION (cont'd)

Activity Information

Name of Propane Supplier(s)			For Office Use - Party No.		
Superior Propane - Ontario Regional Operations Centre					
Street No.	Street Name / 911 Number / Address, if applicable				
251	Woodlawn Road West, Unit 217				
Town / City or Township / Country			Province	Postal Code	
Guelph			Ontario	N1H 8J1	
Telephone No.	Fax No.	Contact Name			
1-877-873-7467	519-836-7766	Mike Mullins			
E-mail					
mullinsm@superiorpropane.com					

Name of Propane Transporter. If same as above, please check box. <input type="checkbox"/>			For Office Use - Party No.		
Superior Propane - North Bay					
Street No.	Street Name / 911 Number / Address, if applicable				
1366	Main St. West				
Town / City or Township / Country			Province	Postal Code	
North Bay			ON	P1B8J1	
Telephone No.	Fax No.	Contact Name			
(705) 471-9202		Lonnie Duquette			
E-mail					
duqettel@superiorpropane.com					

Off-site Cylinder and/or Mobile Storage		Capacity stored off-site, in USWG	For Office Use - Party No.	
None				
Street No.	Street Name / 911 Number / Address, if applicable			
Town / City or Township / Country			Province	Postal Code
Telephone No.	Fax No.	Contact Name		

Note: Customer storage is not considered off-site storage.

Declaration: I am aware that it is an offence to give false information in this document and I hereby declare that the information I have given here is true and complete.

Name of person completing this form (please print)		Official Title	
Kelly Almey		Risk & Safety Coordinator, Superior Propane	
Signature		Telephone No.	Date (dd-mm-yyyy)
		(905) 285-2480 ext. 5549	19-05-2011



Technical Standards and Safety Authority
www.tssa.org

14th Floor - Centre Tower
3300 Bloor Street West
Toronto Ontario M8X 2X4
Fax: 416.231.4903
Customer Service: 1.877.682.8772

Level 1 Risk and Safety Management Plan (RSMP)
Technical Standards and Safety Act
Propane Storage and Handling Regulation

SECTION A: GENERAL INFORMATION (cont'd)

Activity Information

Name of Propane Supplier(s)		For Office Use - Party No.	
Superior Propane - Ontario Regional Operations Centre			
Street No.	Street Name / 911 Number / Address, if applicable		
251	Woodlawn Road West, Unit 217		
Town / City or Township / Country		Province	Postal Code
Guelph		Ontario	N1H 8J1
Telephone No.	Fax No.	Contact Name	
1-877-873-7467	519-836-7766	Mike Mullins	
E-mail			
mullinsm@superiorpropane.com			

Name of Propane Transporter. If same as above, please check box. <input type="checkbox"/>		For Office Use - Party No.	
Superior Propane - North Bay			
Street No.	Street Name / 911 Number / Address, if applicable		
1366	Main St. West		
Town / City or Township / Country		Province	Postal Code
North Bay		ON	P1B8J1
Telephone No.	Fax No.	Contact Name	
(705) 471-9202		Lonnie Duquette	
E-mail			
duquettel@superiorpropane.com			

Off-site Cylinder and/or Mobile Storage	Capacity stored off-site, in USWG	For Office Use - Party No.
None		
Street No.	Street Name / 911 Number / Address, if applicable	
Town / City or Township / Country		Postal Code
Telephone No.	Fax No.	Contact Name

Note: Customer storage is not considered off-site storage.

Declaration: I am aware that it is an offence to give false information in this document and I hereby declare that the information I have given here is true and complete.

Name of person completing this form (please print)	Official Title	
Kelly Almey	Risk & Safety Coordinator, Superior Propane	
Signature	Telephone No.	Date (dd-mm-yyyy)
	(905) 285-2480 ext. 5549	19-05-2011



Technical Standards and Safety Authority
www.tssa.org

14th Floor - Centre Tower
3300 Bloor Street West
Toronto Ontario M8X2X4
Fax: 416.231.4903
Customer Service: 1.877.682.8772

Level 1 Risk and Safety Management Plan (RSMP)
Technical Standards and Safety Act
Propane Storage and Handling Regulation

SECTION B: EMERGENCY AND PREPAREDNESS RESPONSE PLAN

The licence holder will complete Section B in consultation with the local Fire Services.

Description of the maximum volume, types and storage location of other hazardous materials on site, if any.

Gasoline tank stored underground - 2000 litres

Diesel fuel tank stored underground - 2000 litres

An MSDS for regular gasoline is provided herein. MSDS for premium gasoline and diesel are similar and not included.

Description of fire and emergency equipment indicated on facility site map.

Fire Extinguishers at propane dispenser and 4 other fire extinguishers located in the building

List of fire protection controls (e.g., fire detection systems, fire notification systems, alarm systems, automatic shut off devices, fusible links, etc.) and describe their function, use and operation.

1. Fusible link on ISC valve - isolation valve between the tank and the downstream propane dispensing equipment.
2. Emergency stop push button - mounted on a post near the propane tank. This shuts down the pump and closes a solenoid valve upstream of hoses.
3. Power supply breaker inside the gas bar building. This cuts all power to the propane system - shuts down pump; closes solenoid valve.

Maintenance and testing schedule for fire protection controls and devices.

Maintenance and testing is undertaken by Superior Propane according to Superior Propane's Maintenance Standard. Schedule for key equipment is:

1. Pumps (Pump every 3 months; Pump Motor: check belts monthly; grease motor every 6 months)
2. ISC Valves (test for closure every 6 months)
3. Storage tank Relief Valves - inspect every 2 years; replacement schedule as per provincial regulations.

Declaration: I am aware that it is an offence to give false information in this document and I hereby declare that the information I have given here is true and complete.

Name of person completing this form (please print) Nick Bruneau	Official Title Owner <i>PRES.</i>
Signature <i>Nick BRUNEAU</i>	Telephone No. (705)568-8564
	Date (dd-mm-yyyy) 19-05-2011



Technical Standards and Safety Authority
www.tssa.org

14th Floor - Centre Tower
3300 Bloor Street West
Toronto Ontario M8X 2X4
Fax: 416.231.4903
Customer Service: 1.877.682.8772

Level 1 Risk and Safety Management Plan (RSMP)
Technical Standards and Safety Act
Propane Storage and Handling Regulation

SECTION B: EMERGENCY AND PREPAREDNESS RESPONSE PLAN (cont'd)

1. Contacts for Emergency Response

1. Facility Contact Personnel - Key Contact		5. Facility 24-Hour Contact Person	
Name Nick Bruneau	For Office Use - Party No.	Name Nick Bruneau	For Office Use - Party No.
Official Title Owner		Official Title Owner	
Telephone No. (705)568-8564	Fax No. (705)568-6656	Cell No. (705)568-8564	Fax No. (705)568-6656
E-mail Nick@Rontsnowmobile.com		E-mail Nick@Rontsnowmobile.com	
Role and responsibilities in emergency Co-ordinate site response		Role and responsibilities in emergency Coordinate site response	
2. Facility Contact Personnel - Alternate Contact		6. Name of Facility Manager	
Name Paul Bruneau	For Office Use - Party No.	Name Nick Bruneau	For Office Use - Party No.
Official Title Employee		Official Title Owner	
Telephone No. (705)568-8409	Fax No. na	Telephone No. (705)568-8564	Fax No. (705)568-6656
E-mail na		E-mail Nick@Rontsnowmobile.com	
Role and responsibilities in emergency Co-ordinate site response if agent unavailable.		Role and responsibilities in emergency Coordinate site response	
3. Local Fire Services - Key Contact		7. Propane Supplier Key Contact Person	
Name Joe Kmyta	For Office Use - Party No.	Name Superior Propane Hotline	For Office Use - Party No.
Official Title Fire Chief		Official Title	
Telephone No. (705)567-3400	Fax No. na	Telephone No. 1-877-873-7467	Fax No.
E-mail na		E-mail	
Role and responsibilities in emergency Co-ordinate/advise on Kirkland Lake fire service response. Liaise with Police.		Role and responsibilities in emergency Identify and dispatch Superior Propane and or LPERGC emergency response personnel as required	
4. Local Fire Services - Alternate Contact		8. Municipal Contact	
Name Whoever is on shift work that day	For Office Use - Party No.	Name Nancy Allick	
Official Title All are assistant to chief		Official Title CAO	
Telephone No. (705)567-3400	Fax No.	Telephone No. (705)567-9361 ext 236	Fax No.
E-mail		E-mail	
Role and responsibilities in emergency Co-ordinate/advise on Kirkland Lake fire service response. Liaise with Police.		Municipality Kirkland Lake	

Declaration: I am aware that it is an offence to give false information in this document and I hereby declare that the information I have given here is true and complete.

Name of person completing this form (please print) Nick Bruneau	Official Title Owner
Signature	Telephone No. (705)568-8564
	Date (dd-mm-yyyy) 19-05-2011



Technical Standards and Safety Authority
www.tssa.org

14th Floor - Centre Tower
3300 Bloor Street West
Toronto Ontario M8X 2X4
Fax: 416.231.4903
Customer Service: 1.877.682.8772

Level 1 Risk and Safety Management Plan (RSMP)
Technical Standards and Safety Act
Propane Storage and Handling Regulation

SECTION B: EMERGENCY AND PREPAREDNESS RESPONSE PLAN (cont'd)

2. Additional Safety Measures

Describe any other measures in place at the facility that exceed the minimum Code and Standards requirements.

Emergency stop push button - Auto Motor

Emergency electric stop push button

Declaration: I am aware that it is an offence to give false information in this document and I hereby declare that the information I have given here is true and complete.

Name of person completing this form (please print) Nick Bruneau	Official Title Owner	
Signature	Telephone No. (705)568-8564	Date (dd-mm-yyyy) 19-05-2011



Technical Standards and Safety Authority
www.tssa.org

14th Floor - Centre Tower
3300 Bloor Street West
Toronto Ontario M8X 2X4
Fax: 416.231.4903
Customer Service: 1.877.682.8772

Level 1 Risk and Safety Management Plan (RSMP)
Technical Standards and Safety Act
Propane Storage and Handling Regulation

SECTION B: EMERGENCY AND PREPAREDNESS RESPONSE PLAN (cont'd)

3. Record of Emergency Training Provided - For most recent 12-month period.

Training on Emergency Response Plan and Procedures provided to facility key contacts.

Training Date (dd-mm-yyyy) none	Print Name of Training Provider:
	Print Name of Instructor:
Training Date (dd-mm-yyyy)	Print Name of Training Provider:
	Print Name of Instructor:
Training Date (dd-mm-yyyy)	Print Name of Training Provider:
	Print Name of Instructor:

Training on the facility's Emergency Management Procedures provided to staff.

Training Date (dd-mm-yyyy) none	Print Name of Training Provider:
	Print Name of Instructor:
Training Date (dd-mm-yyyy)	Print Name of Training Provider:
	Print Name of Instructor:
Training Date (dd-mm-yyyy)	Print Name of Training Provider:
	Print Name of Instructor:

On-site specific training provided to certificate holders / persons with Records of Training.

Training Date (dd-mm-yyyy) 30-08-2008	Print Name of Training Provider: Ontario Propane Association - PLEASE NOTE THAT ROT TRAINING IS VALID FOR
	Print Name of Instructor: OPA 3 YEARS
Training Date (dd-mm-yyyy)	Print Name of Training Provider:
	Print Name of Instructor:
Training Date (dd-mm-yyyy)	Print Name of Training Provider:
	Print Name of Instructor:

Declaration: I am aware that it is an offence to give false information in this document and I hereby declare that the information I have given here is true and complete.

Name of person completing this form (please print) Nick Bruneau	Official Title Owner
Signature	Telephone No. (705)568-8564
	Date (dd-mm-yyyy) 19-05-2011



Technical Standards and Safety Authority
www.tssa.org

14th Floor - Centre Tower
3300 Bloor Street West
Toronto Ontario M8X2X4
Fax: 416.231.4903
Customer Service: 1.877.682.8772

Level 1 Risk and Safety Management Plan (RSMP)
Technical Standards and Safety Act
Propane Storage and Handling Regulation

SECTION B: EMERGENCY AND PREPAREDNESS RESPONSE PLAN (cont'd)

4. Emergency Training Plan for Coming Year

Training on Emergency Response Plan and Procedures provided to facility key contacts.

Target Date (dd-mm-yyyy) Q4 (2011)	Print Name of Training Provider: Superior Propane or Alternate - PLEASE NOTE THAT THE COURSE CONTENT IS CURRENTLY BEING DEVELOPED BY THE TSSA
	Print Name of Instructor: to be arranged
Target Date (dd-mm-yyyy)	Print Name of Training Provider: WITH THE INTENTION THAT IT AND ITS' PROVIDER
	Print Name of Instructor: WILL BE READY TO DELIVER THIS TRAINING IN
Target Date (dd-mm-yyyy)	Print Name of Training Provider: THE FOURTH QUARTER OF THIS YEAR
	Print Name of Instructor:

Training on the facility's Emergency Management Procedures provided to staff.

Target Date (dd-mm-yyyy) Q4 (2011)	Print Name of Training Provider: Key site contact to train staff
	Print Name of Instructor:
Target Date (dd-mm-yyyy)	Print Name of Training Provider:
	Print Name of Instructor:
Target Date (dd-mm-yyyy)	Print Name of Training Provider:
	Print Name of Instructor:

On-site specific training provided to certificate holders / persons with Records of Training.

Target Date (dd-mm-yyyy) As Required	Print Name of Training Provider: Superior Propane , FSN, or Other - PLEASE NOTE THAT ROT TRAINING IS VALID
	Print Name of Instructor: to be arranged FOR 3 YEARS
Target Date (dd-mm-yyyy)	Print Name of Training Provider:
	Print Name of Instructor:
Target Date (dd-mm-yyyy)	Print Name of Training Provider:
	Print Name of Instructor:

Declaration: I am aware that it is an offence to give false information in this document and I hereby declare that the information I have given here is true and complete.

Name of person completing this form (please print) Nick Bruneau	Official Title Owner
Signature	Telephone No. (705)568-8564
	Date (dd-mm-yyyy) 19-05-2011



Technical Standards and Safety Authority
www.tssa.org

14th Floor - Centre Tower
3300 Bloor Street West
Toronto Ontario M8X 2X4
Fax: 416.231.4903
Customer Service: 1.877.682.8772

Level 1 Risk and Safety Management Plan (RSMP)
Technical Standards and Safety Act
Propane Storage and Handling Regulation

SECTION B: EMERGENCY AND PREPAREDNESS RESPONSE PLAN (cont'd)

The licence holder will complete Section B in consultation with the local Fire Services.

5. Emergency Response Communications Plan

Warnings and Actions

Describe who gives warnings to whom, and how and when the warning will be given (including public notification as appropriate).
The operator or alternate will contact emergency services by calling 911 and will provide warnings outlined in the attached "Propane Emergency Response Procedures" card (to be posted on site and part of the employee training). If it is safe to do so this could involve advising neighbors to evacuate.
The owner/operator may also contact Superior Propane via the emergency number identified in the ERP.

Describe what action is to be taken and by whom when a warning is issued (including details of a meeting place in a safe identified area and activating the evacuation plan, if necessary).
The owner/operator or alternate should first follow the actions in the ERP provided herein. Staged evacuation, if the release of propane cannot be stopped by cutting electrical power may be required. Initial muster location will be on Kirkland St East, at least 80 m from the site and away from a dispensing cloud. Subsequent evacuation instructions potentially up to the Hazard Distance to be provided by municipal emergency responders.

Communication with Emergency Response Authorities

Describe when and how the licence holder will give early warning to emergency response authorities (including a process to ensure that a call is placed to 911).
When the system is operational, a ROT person will be on duty and be in the propane tank area. The key contact or alternate will be implementing ER actions including notifying emergency responders. Calling 911 will occur immediately after any attempts to shut down the system.

When the system is not in operation, the ISC valve (main isolation valve) is closed, and the propane system is unattended but shutdown.
Any accidents involving the propane tank during such times will require the intervention of random, nearby individuals or store staff.

Describe provisions for fire department entry when there are no operations or staffing at the propane site.
The propane tank system is located in a wide open area that is easily accessible to Kirkland Street East and Station Road South.
These fire access routes are identified in the attached site plan.

Describe how the licence holder will ensure continual flow of updated information to authorities.
The critical information required from the license holder is information on how to shut down the system and the fill level in the tank (if known).
Fill level is relevant from a time-to-BLEVE perspective (a near empty tank will BLEVE sooner than a full tank if there is fire impingement on the tank).
This information will be provided to the authorities by Nick Bruneau..

How long will it take the facility liaison person to respond to the site.
20 minutes

Declaration: I am aware that it is an offence to give false information in this document and I hereby declare that the information I have given here is true and complete.

Name of person completing this form (please print) Nick Bruneau	Official Title Owner	
Signature	Telephone No. (705)568-8564	Date (dd-mm-yyyy) 19-05-2011



Technical Standards and Safety Authority
www.tssa.org

14th Floor - Centre Tower
3300 Bloor Street West
Toronto Ontario M8X2X4
Fax: 416.231.4903
Customer Service: 1.877.682.8772

Level 1 Risk and Safety Management Plan (RSMP)
Technical Standards and Safety Act
Propane Storage and Handling Regulation

SECTION B: EMERGENCY AND PREPAREDNESS RESPONSE PLAN (cont'd)

The licence holder will complete Section B in consultation with the local Fire Services.

6. Building and Site Security and Procedures

	Yes	No
1. Does the propane location have controlled access to limit unnecessary risk and entry (lock out procedures)?	<input checked="" type="checkbox"/>	<input type="checkbox"/>
2. Is there adequate night lighting at the site?	<input type="checkbox"/>	<input checked="" type="checkbox"/>
3. Are procedures in place that ensure access routes, aisles, storage area, filling areas and the grounds are kept clear from unwanted materials?	<input checked="" type="checkbox"/>	<input type="checkbox"/>
4. Are there procedures that capture and record the daily inspection of hoses and inspection requirements for filling systems and mechanical devices used in the transfer of propane?	<input checked="" type="checkbox"/>	<input type="checkbox"/>
5. Does the facility have procedures that include a process to isolate and purge any overfilled propane cylinders?	<input checked="" type="checkbox"/>	<input type="checkbox"/>
6. Are weighing systems validated for accuracy?	<input checked="" type="checkbox"/>	<input type="checkbox"/>
7. Are storage areas clearly marked with the vessels' capacity status (i.e., filled, empty, purged and other hazardous materials)?	<input checked="" type="checkbox"/>	<input type="checkbox"/>
8. Are quality assurance procedures in place to ensure that all valves are closed after the propane cylinders are filled?(e.g., QCC valves)	<input checked="" type="checkbox"/>	<input type="checkbox"/>
9. Is the schedule of maintenance and testing activities retained on site?	<input checked="" type="checkbox"/>	<input type="checkbox"/>

7. Water Supply

The propane licence holder should work with the local fire department to determine water supply capabilities that are available based on the propane facility's location.

	Yes	No
1. Is a pressurized water system available at the propane facility site?	<input checked="" type="checkbox"/>	<input type="checkbox"/>
2. Can the municipal fire department pump 375 GPM (1420 LPM) of water at this location?	<input checked="" type="checkbox"/>	<input type="checkbox"/>
3. What is the unobstructed distance to the closest water supply that could be used for firefighting activities? (distance in metres only)	33 m	
4. What is the unobstructed distance to the closest approved water supply with year round access if there are no hydrants? (distance in metres only)	33 m	

Declaration: I am aware that it is an offence to give false information in this document and I hereby declare that the information I have given here is true and complete.

Name of person completing this form (please print) Nick Bruneau	Official Title Owner	
Signature 	Telephone No. (705)568-8564	Date (dd-mm-yyyy) 19-05-2011



Technical Standards and Safety Authority
www.tssa.org

14th Floor - Centre Tower
3300 Bloor Street West
Toronto Ontario M8X 2X4
Fax: 416.231.4903
Customer Service: 1.877.682.8772

Level 1 Risk and Safety Management Plan (RSMP)
Technical Standards and Safety Act
Propane Storage and Handling Regulation

SECTION B: EMERGENCY AND PREPAREDNESS RESPONSE PLAN (cont'd)

The licence holder will complete Section B in consultation with the local Fire Services.

8. Licence holder and local Fire Services Review

To be completed by the Local Fire Services

Has the local fire service had an opportunity to review the Emergency Response and Preparedness Plan?

Yes No

If not, please explain (e.g., no fire services).

IT IS RECOMMENDED THAT ALL EMPLOYEES PARTICIPATE IN FIRST AID FIRE EXTINGUISHER TRAINING AT LEAST ONCE ANNUALLY.

Fire services comments, if any:

To be completed by the Licence Holder

In response to the above comments, the following action(s) is required:

The licence holder will respond to the Local Fire Services comments by: _____ (dd-mm-yyyy)

LOCAL FIRE SERVICES

The undersigned has reviewed Section B of the Risk and Safety Management Plan Fire Services.

Print name KIRKLAND LAKE FIRE SERVICES Local Fire Services Name	Signature 	Date (dd-mm-yyyy) 23 JUN 2011
--	---	---

Declaration: I am aware that it is an offence to give false information in this document and I hereby declare that the information I have given here is true and complete.

Name of person completing this form (please print)	Official Title	
Signature	Telephone No.	Date (dd-mm-yyyy)



Technical Standards and Safety Authority
www.tssa.org

14th Floor - Centre Tower
3300 Bloor Street West
Toronto Ontario M8X 2X4
Fax: 416.231.4903
Customer Service: 1.877.682.8772

Level 1 Risk and Safety Management Plan (RSMP)
Technical Standards and Safety Act
Propane Storage and Handling Regulation

SECTION C: SUBMISSIONS

Applicant must include a Facility Site Plan and Map of Surrounding Area

Facility Site Plan.

The licence holder will submit a copy of the original facility site plan updated with the following information:

1. The storage location of fixed, portable, and mobile vessels.
2. The maximum volume, types and storage location of hazardous materials.
3. Location of permanent structures on site.
4. Access and egress points and location of barriers.
5. Location of fire and emergency equipment (e.g., sprinkler systems, extinguishers, suppression systems) on site and location of fire hydrant or water supply where available.
6. Location of emergency shut off/shut down switches/valves.

Map of Surrounding Area.

The licence holder will submit a scaled aerial map of the surrounding area showing the following information:

7. The capacity and placement of the single largest propane storage vessel, including its setback from the front, rear and side property lines.
8. GPS co-ordinates of the single largest vessel.
9. Visual indication of the single largest fixed vessel and a circle made using the distance in Table 1 as the radius from the single largest fixed vessel.
10. Clear indication of the municipality or municipalities present within the circle.
11. Visual indication of property line information.
12. The location and name of roads within or abutting the site.
13. Key note to the drawing indicating the facility's municipal address, municipal lot number(s) and concession lines as applicable, and the date the map was prepared.
14. Address and contact information for each municipality (municipal clerk or secretary-treasurers of planning board). (Refer to page 5.)
15. Complete "Required Mapping Information from Updated Site Plan" in table below .

Required Mapping Information from Updated Site Plan

Date Map Prepared (dd-mm-yyyy) 12-05-2011	Capacity of single largest propane storage vessel (USWG) 2000 USWG
Tank setback coordinates. Indicate placement on the map.	
Front: 25 ft _____	Right side property line: 170 ft _____
Rear: 80 ft _____	Left side property line: 18 ft _____
GPS coordinates of single largest vessel: Lat. 48.151269, Long. -80.029312	

Declaration: I am aware that it is an offence to give false information in this document and I hereby declare that the information I have given here is true and complete.

Name of person completing this form (please print) Nick Bruneau	Official Title Owner	
Signature 	Telephone No. (705)568-8564	Date (dd-mm-yyyy) 19-05-2011



Technical Standards and Safety Authority
www.tssa.org

14th Floor - Centre Tower
3300 Bloor Street West
Toronto Ontario M8X2X4
Fax: 416.231.4903
Customer Service: 1.877.682.8772

Level 1 Risk and Safety Management Plan (RSMP)
Technical Standards and Safety Act
Propane Storage and Handling Regulation

SECTION C: SUBMISSIONS (cont'd)

Applicant must include a Facility Site Plan and Map of Surrounding Area

Table 1: Distance Table

Water Capacity (litres)	Nominal Water Capacity (USWG)	Distance to 1 psi overpressure (m)
1,890	500	155
3,780	1,000	195
4,920	1,300	213
6,620	1,750	235
7,130	1,885	241
7,560	2,000	246
18,900	5,000	333

Formula: $D = 16.94 \times (1.524 \times C)^{1/3}$
 D = Distance to overpressure of 1 psi (meters)
 C = Tank Total Capacity in USWG

Parameters: Density of Propane is 0.5033 kg per litre @ 15 C
 Assume all vessels are 80% full
 1 gallon [US, liquid] = 0.003785411784 cubic meter
 1 cubic metre = 264.17 USWG

Hazard Distance Chart (EPA-TNT model)

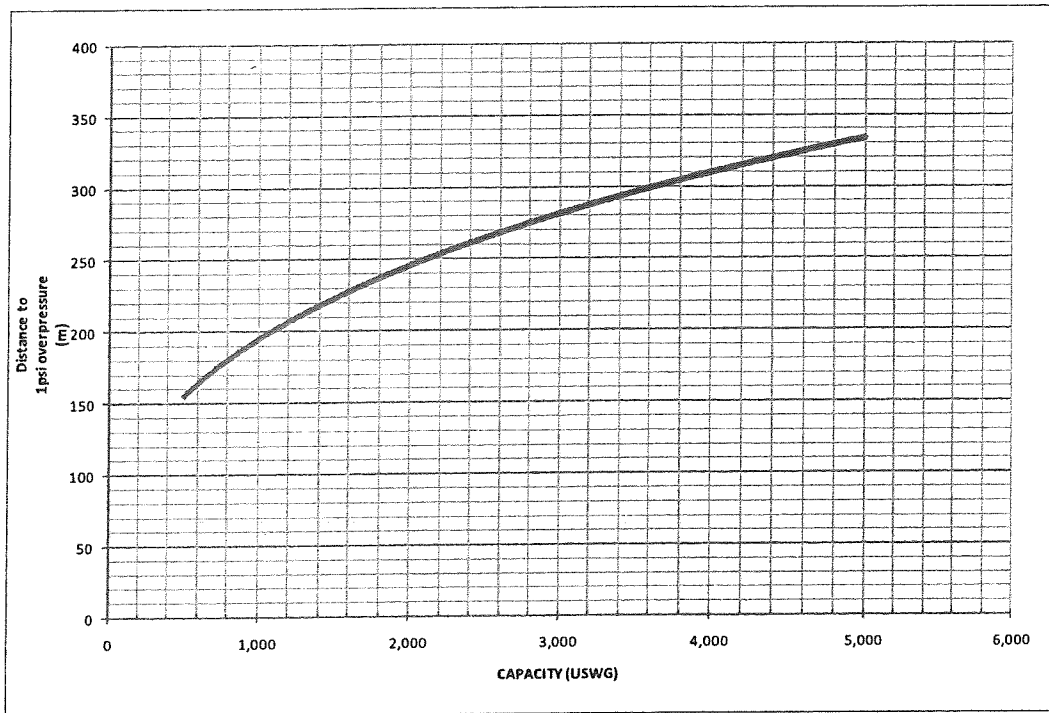

Declaration: I am aware that it is an offence to give false information in this document and I hereby declare that the information I have given here is true and complete.

Name of person completing this form (please print) Nothing completed on this page.		Official Title	
Signature		Telephone No.	Date (dd-mm-yyyy)



Technical Standards and Safety Authority
www.tssa.org

14th Floor - Centre Tower
3300 Bloor Street West
Toronto Ontario M8X2X4
Fax: 416.231.4903
Customer Service: 1.877.682.8772

Level 1 Risk and Safety Management Plan (RSMP)
Technical Standards and Safety Act
Propane Storage and Handling Regulation

SECTION C: SUBMISSIONS (cont'd)

Applicant must include a Facility Site Plan and Map of Surrounding Area

As an accompaniment to the Map of Surrounding Area, provide the following information about buildings and features present within the circle in Table 2.

Table 2: Buildings and Features

Buildings and Features Present within the Circle on the Map of the Surrounding Area AND Name and Address of Closest Building or Feature	* Number of Buildings and Features (mark with an "X")				Distance from Tank to Closest Building or Feature
	0	1	2-10	11+	
Industrial buildings or parks or golf courses Name: <u>SECOND STREET PARK</u> Address: <u>42 SECOND ST</u> City: <u>KIRKLAND LAKE</u> Province <u>ON</u> Postal Code _____		X			<u>250</u> m
Residential building units specifically permanent single family dwellings, condominiums, and apartments. [REDACTED]		X			<u>236</u> m
Commercial building units specifically retail, restaurants, entertainment, theatres, and sporting complexes. Name: <u>GRANT'S HOME HARDWARE</u> Address: <u>15 KIRKLAND ST</u> City: <u>KIRKLAND LAKE</u> Province <u>ON</u> Postal Code _____		X			<u>180</u> m
Commercial building units - continuous occupancy specifically hotels, campgrounds, and resorts. Name: <u>TRUE CENTRE</u> Address: <u>40 TOWER ST</u> City: <u>KIRKLAND ST</u> Province <u>ON</u> Postal Code _____		X			<u>28</u> m
Sensitive institutions specifically hospitals, schools and day cares, nursing and retirement homes, mental health institutions, and prisons. Name: <u>CENTRAL SCHOOL</u> Address: <u>STATION RD</u> City: <u>KIRKLAND LAKE</u> Province <u>ON</u> Postal Code _____		X			<u>54</u> m
Emergency responders specifically fire stations, ambulance stations, and police stations. Name: <u>NONE</u> Address: _____ City: _____ Province _____ Postal Code _____					_____ m

* For multi-unit buildings, count each unit as "1".

Declaration: I am aware that it is an offence to give false information in this document and I hereby declare that the information I have given here is true and complete.

Name of person completing this form (please print) Nick Bruneau	Official Title (<u>PRES.</u>)
Signature 	Telephone No. (705)568-8564
	Date (dd-mm-yyyy) <u>21/01/14</u>



Technical Standards and Safety Authority
www.tssa.org

14th Floor - Centre Tower
3300 Bloor Street West
Toronto Ontario M8X 2X4
Fax: 416.231.4903
Customer Service: 1.877.682.8772

Level 1 Risk and Safety Management Plan (RSMP)
Technical Standards and Safety Act
Propane Storage and Handling Regulation

SECTION C: SUBMISSIONS (cont'd)

Applicant must include a Facility Site Plan and Map of Surrounding Area

Portable Storage Additional Information Sheet

Cylinder Size	Capacity in USWG	Quantity	Total Volume in USWG
# 420	123.9		
# 100	29.5	15	442.5
# 40	11.75		
# 33.3	9.62	3	28.86
# 30	8.8	5	44
# 20	5.8	25	145
# 10	2.9		
# 5	1.5		
Total Cylinder Capacity 660.36 USWG			

Tanks Stored On-site Not Connected for Use

Tank Size In USWG	Quantity	Total Volume in USWG
None 2000	1	2000 USWG
Total Tank Capacity		

Total Cylinder Capacity	660 USWG
Total Tank Capacity	2000 USWG
Total Portable Capacity	660 USWG

Declaration: I am aware that it is an offence to give false information in this document and I hereby declare that the information I have given here is true and complete.

Name of person completing this form (please print) Nick Bruneau	Official Title Owner	
Signature 	Telephone No. (705)568-8564	Date (dd-mm-yyyy) 19-05-2011

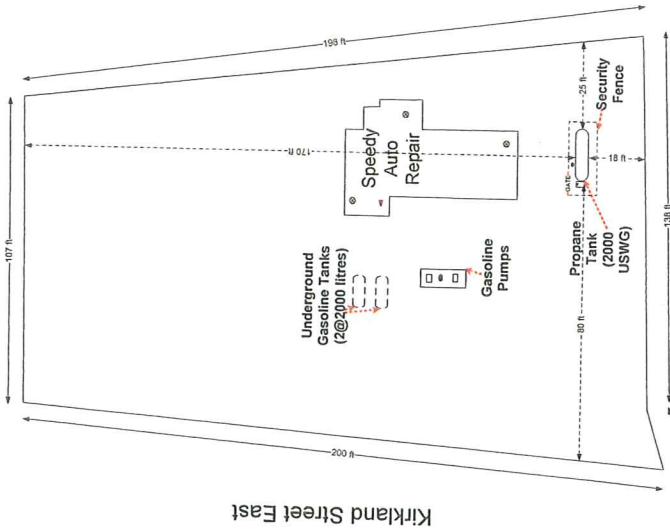

Key Plan:



Notes:

1. Tank distances to property lines:

Property Line Setbacks	Distance
East (Right Side)	170 ft
South (Front Side)	25 ft
West (Left Side)	18 ft
North (Back Side)	80 ft

2. Fire Extinguisher

3. Egress/Fire Access Route:
Site is wide open, egress/access from Kirkland St East and Station Road.

4. E-Stop

Superior Propane Ltd.

Title: **Site Plan**

Speedy Auto Repair

16 Kirkland St E, Kirkland Lake, On, P2N 1P3

PT 8818 CST PT Mining Claim Lot 1635
Township of Teck.

Drawn by: L. Forget

Checked by: C. Britskey

Date: May 11, 2011

Rev 0

Town of Kirkland Lake



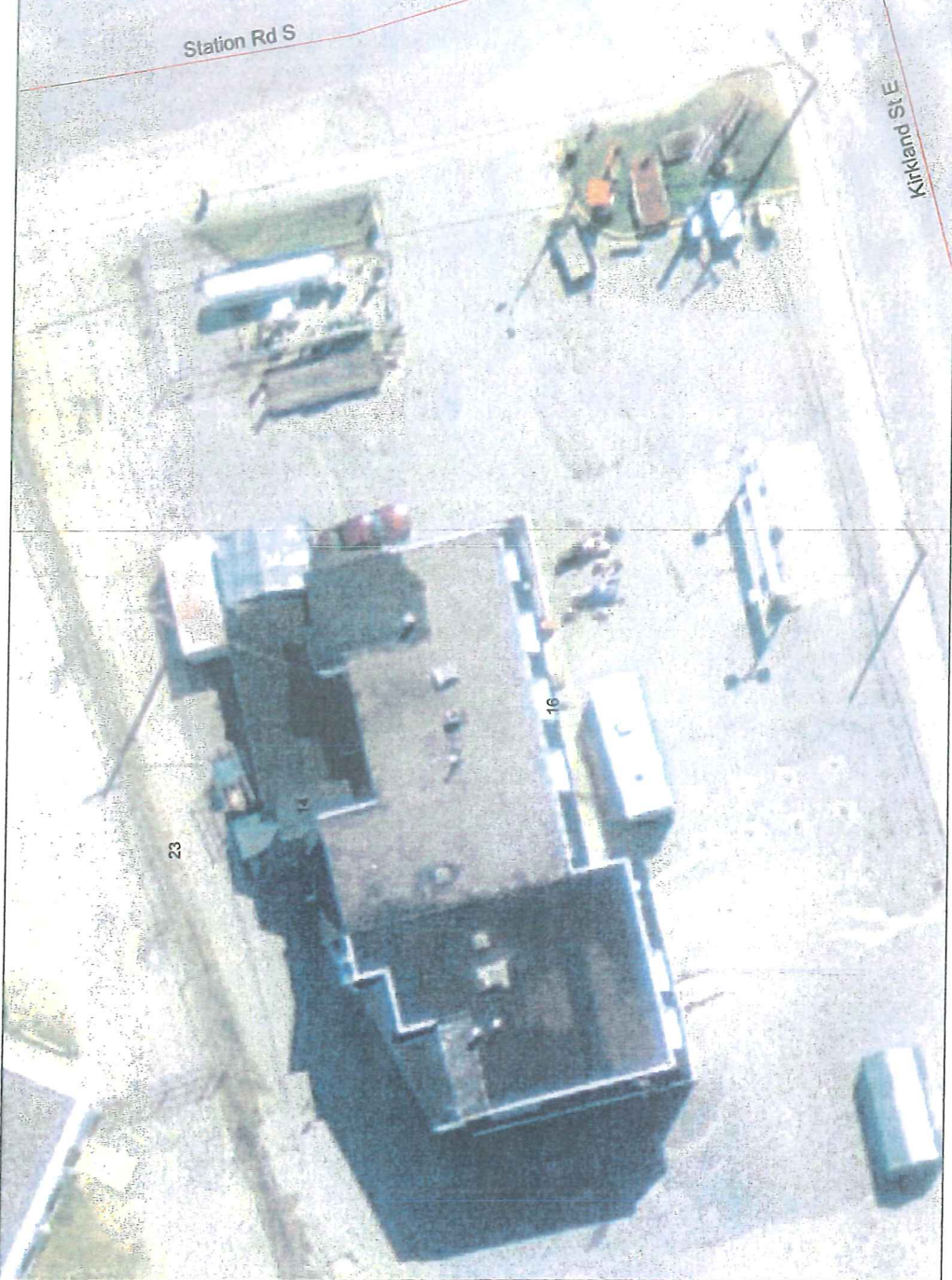



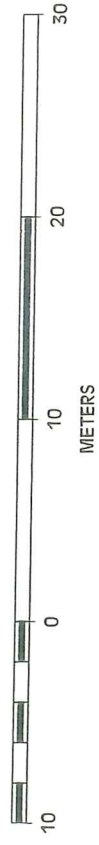









	Bridge
	Railway
	Roads with Names
	Roads without Names
Aerial Photography	
	6cm Aerial Photography (Spring 2007)
	FRI Imagery - 40cm
	Lakes
	Civic Addresses
	Ontario Municipalities



SCALE 1 : 374



Town of Kirkland Lake

	Bridge
	Railway
	Roads with Names
	Roads without Names
	Buffer layer
Aerial Photography	
	Parcel Boundaries
	6cm Aerial Photography (Spring 2007)
	FRI Imagery - 40cm
	Lakes
Parcel Issues	
	Parcels - Crown Land Not in OASYS
	Parcels - Roll # Not Available
	Parcels - Roll # Not in OASYS
	Parcels - Many Roll # on MPAC maps
	Parcels - Crown Land in OASYS
	Parcels
	Civic Addresses
	Ontario Municipalities

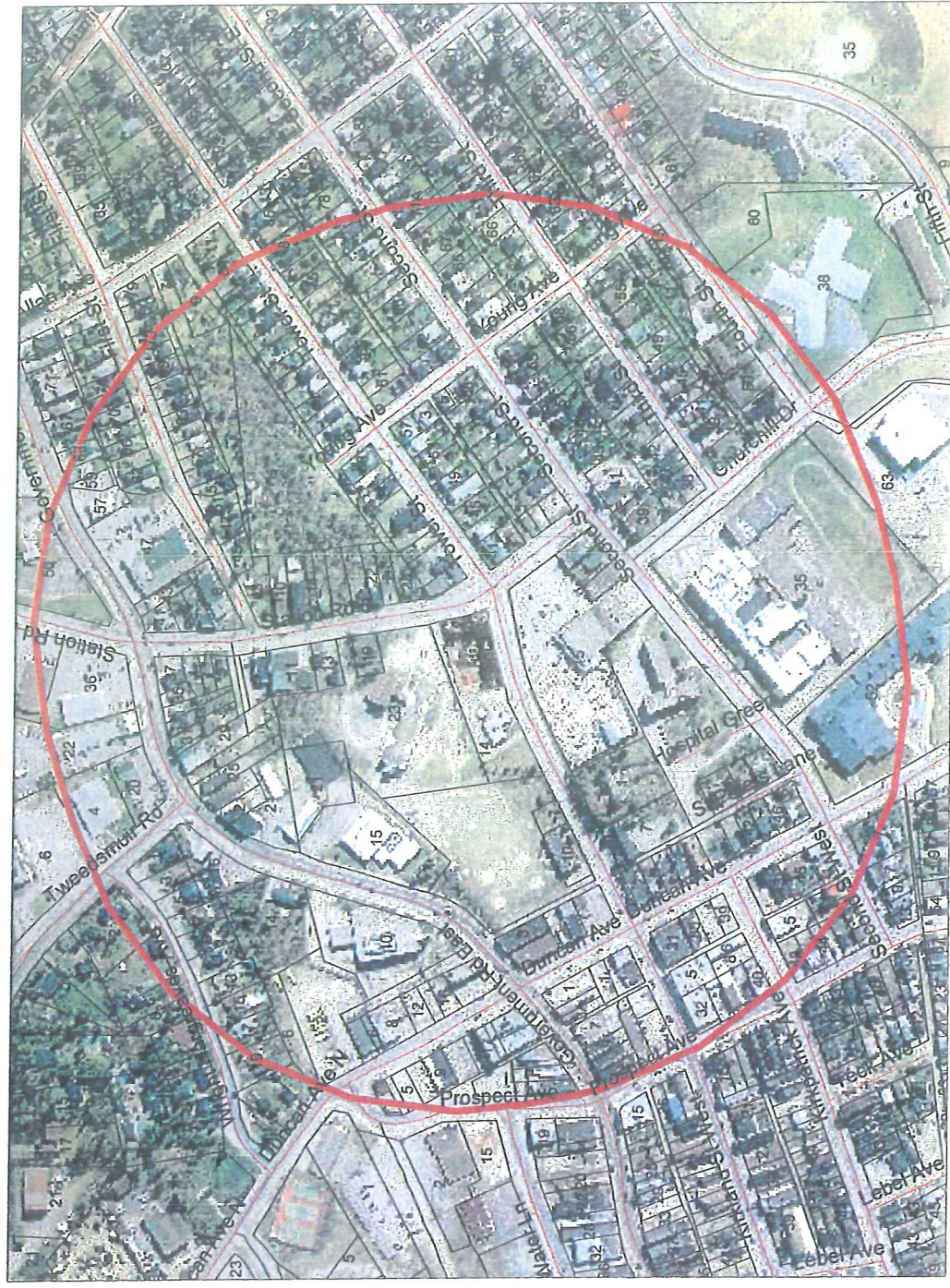

SCALE 1 : 5,072

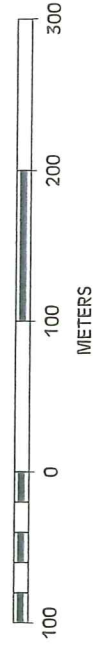

Town of Kirkland Lake

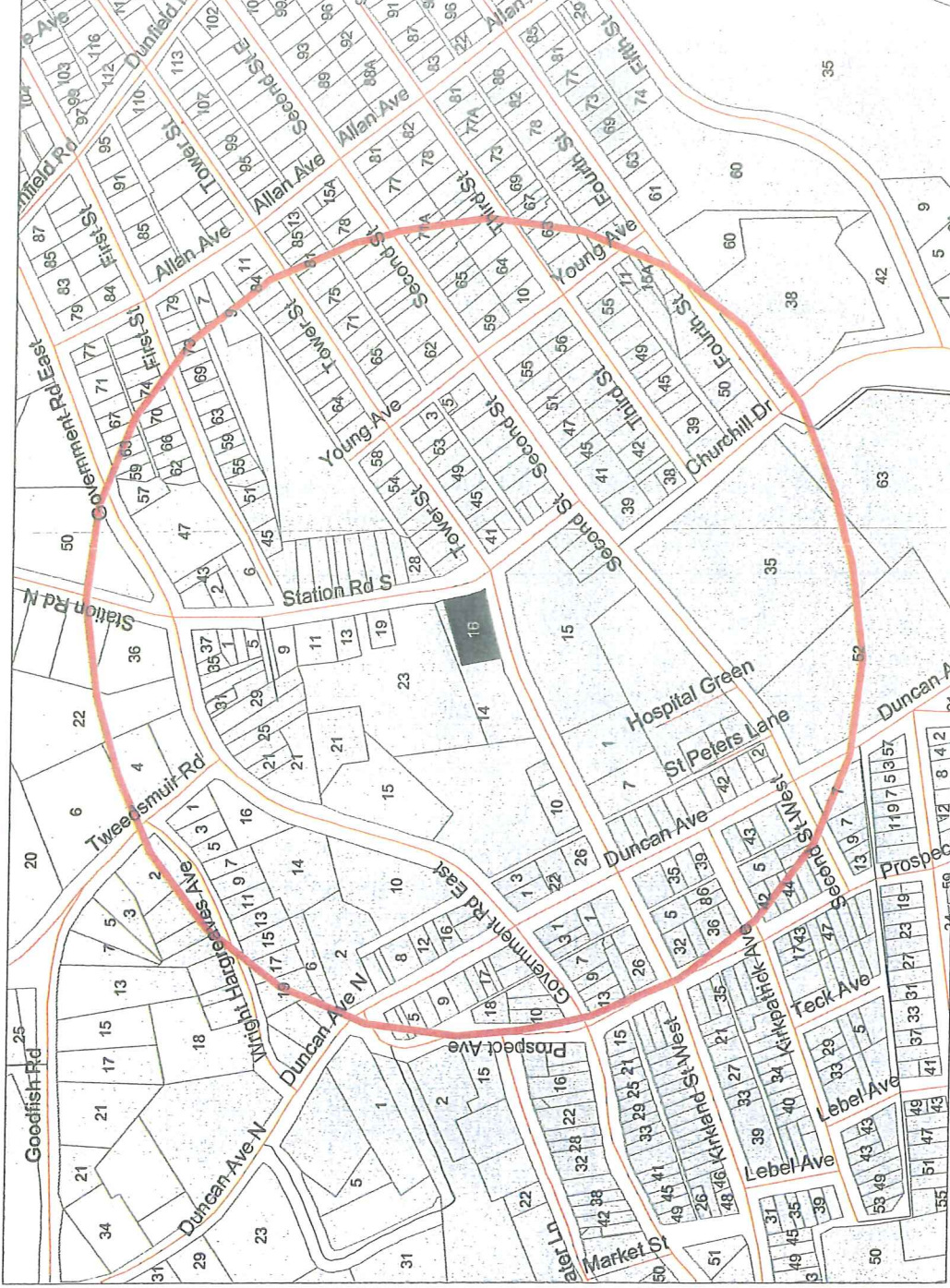
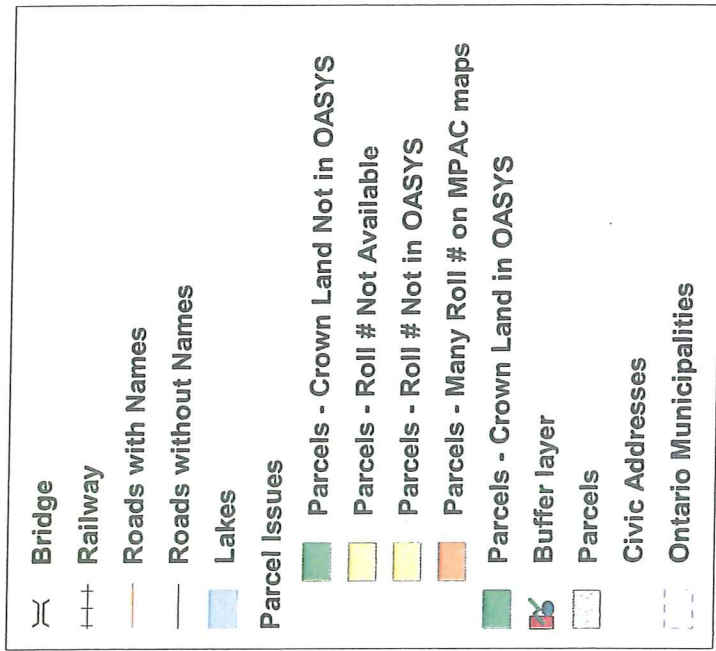

SCALE 1 : 5,696

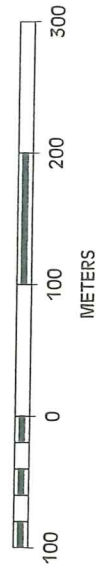

Town of Kirkland Lake

	Bridge
	Railway
	Roads with Names
	Roads without Names
	Lakes
	Parcel Issues
	Parcels - Crown Land Not in OASYS
	Parcels - Roll # Not Available
	Parcels - Roll # Not in OASYS
	Parcels - Many Roll # on MPAC maps
	Parcels - Crown Land in OASYS
	Buffer layer
	Parcels
	Civic Addresses
	Ontario Municipalities

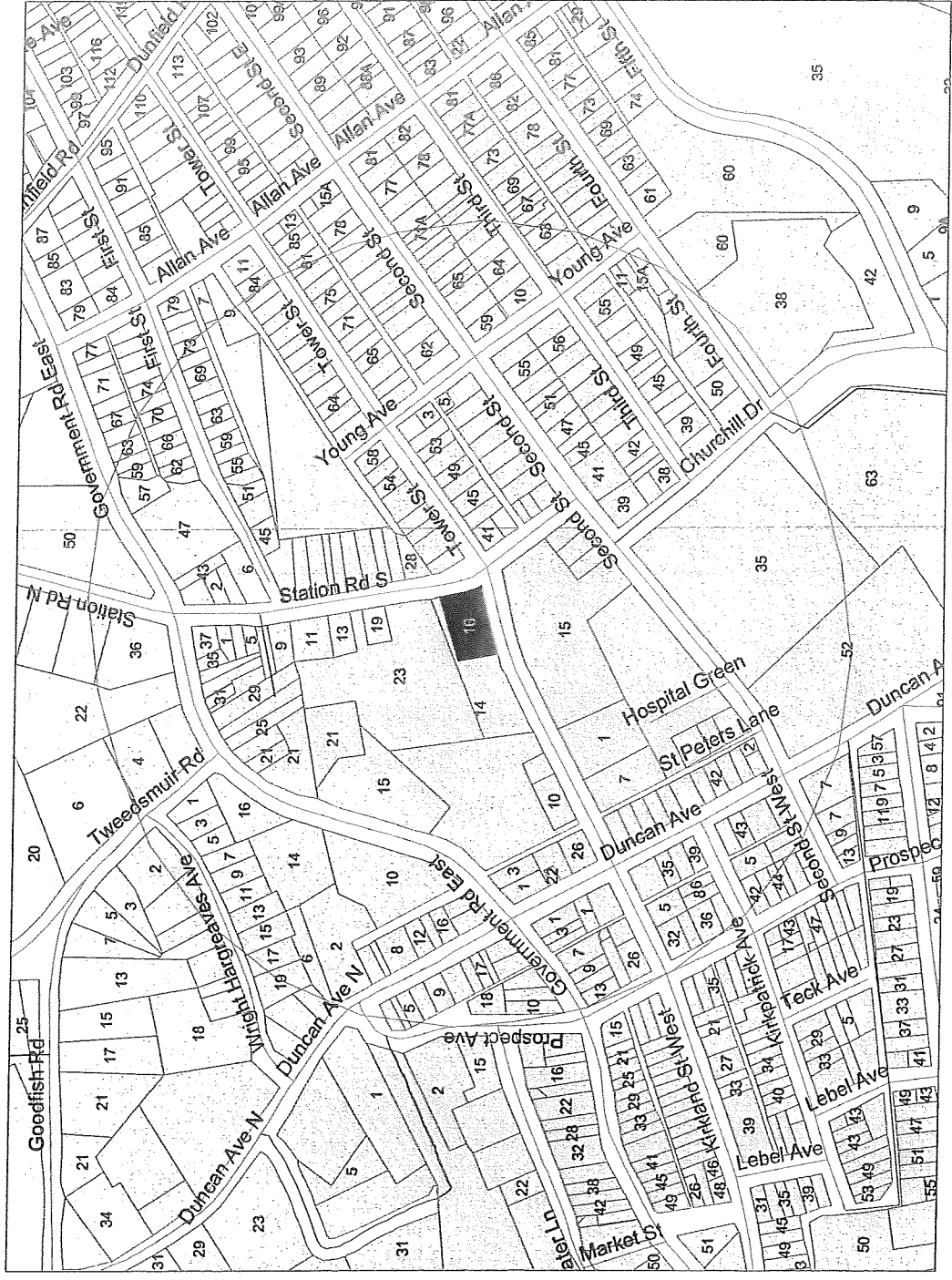

SCALE 1 : 5,696

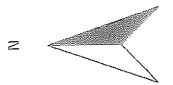
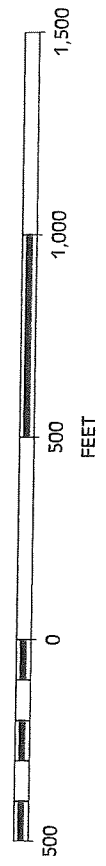

Risk and Safety Management Plan Area Map Showing PUBLIC RECEPTORS WITHIN HAZARD DISTANCE

Town of Kirkland Lake

Scale: 1:3 000

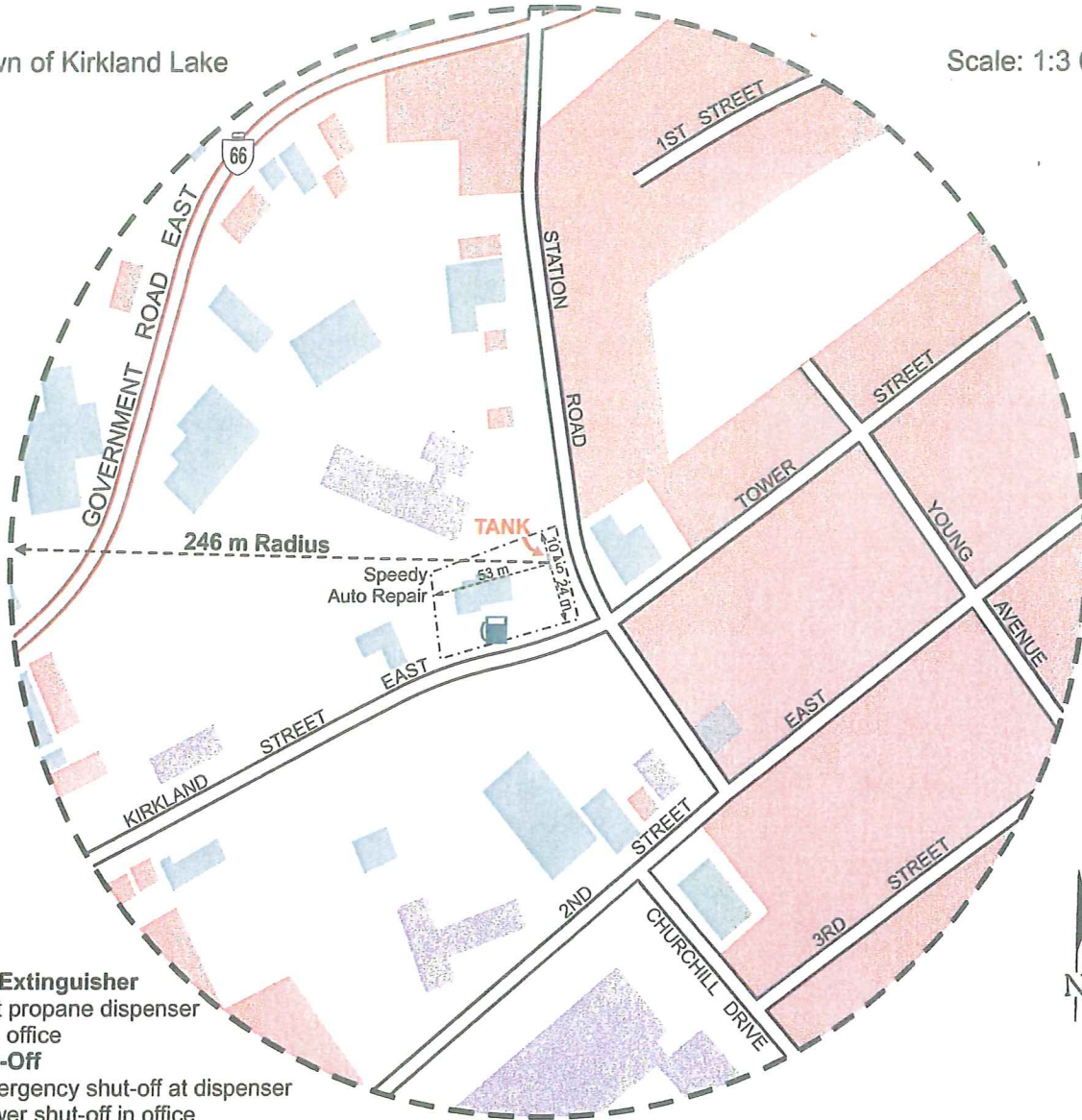

- Fire Extinguisher**
- 1 at propane dispenser
 - 1 in office
- Shut-Off**
- Emergency shut-off at dispenser
 - Power shut-off in office

LEGEND	
	Industrial/Park
	Office/Retail/Restaurant
	Residential
	Sensitive Institution
	Gas Station
	Highway
	Road
	Property Boundary

Municipal Contact
Nancy Allecki, CAO Kirkland Lake
Telephone: 705-567-9361 x236

GPS Coordinates
48.1512 N, -80.0293 W

Nomimal Water Capacity (USWG)	Distance to Endpoint (m)
500	155
1000	195
1,300	213
1,750	235
1,885	241
2,000	246
5,000	333

KennKart Digital Mapping ©2011

Superior Propane Inc. ©2011

Speedy Auto Repair Ltd.

16 Kirkland Street East, Kirkland Lake, Ontario, Canada, P2N 1P3
Part of Mining Location L-1635, Township of Teck, District of Timiskaming