



Technical Standards and Safety Authority
 www.tssa.org

14th Floor - Centre Tower
 3300 Bloor Street West
 Toronto Ontario M8X 2X4
 Fax: 416.231.4903
 Customer Service: 1.877.682.8772

Level 1 Risk and Safety Management Plan (RSMP)
 Technical Standards and Safety Act
 Propane Storage and Handling Regulation

- This Level 1 RSMP applies to:
- a facility with a total propane storage capacity of 5,000 USWG or less; or
 - a facility with a fixed propane storage capacity of exactly 5,000 USWG and no more than 500 USWG of portable propane storage capacity on site.

Failure to fully complete this form may result in rejection. Making a false statement may result in a fine or prosecution under the *Technical Standards and Safety Act*

Licence Number: 0076647660

Check applicable type of propane operations.

Cylinder Motor Fill Filling Plant Card/Keylock

Submit along with this completed application a Facility Site Plan and a Map of the Surrounding Area.

For Office Use Only

SR# [REDACTED]

SECTION A: GENERAL INFORMATION

The Undersigned applies to TSSA for a review for an RSMP under Ontario's *Technical Standards and Safety Act*, Propane Storage and Handling Regulation.

Company Name: AirBoss Rubber Compounding Ontario Corporation No., if applicable: [REDACTED]

Operator Name (if different from above): [REDACTED]

Telephone No.: 519-576-5565, x 3062 Fax No.: 519-576-1315 E-mail: rkauk@airboss.ca (Mr. Richard Kauk)

Street No.: 101 Street Name / 911 Number / Address, if applicable: Glasgow Street

Town / City or Township / County: KITCHENER Province: ONTARIO Postal Code: N2G 4X8

Mailing address if different from above:

Street No.: [REDACTED] Street Name / 911 Number / Address, if applicable: [REDACTED]

Town / City or Township / County: [REDACTED] Province: [REDACTED] Postal Code: [REDACTED]

Information on Container Refill Centre or Filling Plant

Location of facility:

Street No.: 101 Street Name / 911 Number / Address, if applicable: Glasgow Street Nearest Major Intersection: On Glasgow Street, between York Street and Park Street

Town / City or Township / County: KITCHENER Province: ONTARIO Postal Code: N2G 4X8

Name of Licence Holder: AirBoss Rubber Compounding

Name of a Senior Management person as defined in the regulation holding the Record of Training (ROT): Robert Dodd, Vice-President ROT type: Propane Plant Operator-3 (PPO-3)

Municipality (or municipalities if the facility or its hazard distance touches multiple borders): City of Kitchener

Hours of operation: [REDACTED]

This document is valid until the next licence renewal date. You are required by law to notify TSSA of any change of information.

Declaration: I am aware that it is an offence to give false information in this document and I hereby declare that the information I have given here is true and complete.

Print name	Signature	Date (dd-mm-yyyy)
Name of Licence Holder: AirBoss Rubber Compounding	[Signature]	27-10-11
Name of Senior Management person as defined in the Regulation holding the Record of Training: Mr. Robert Dodd, Vice-President	[Signature]	20-08-2011



Technical Standards and Safety Authority
www.tssa.org

14th Floor - Centre Tower
3300 Bloor Street West
Toronto Ontario M8X 2X4
Fax: 416.231.4903
Customer Service: 1.877.682.8772

Level 1 Risk and Safety Management Plan (RSMP)

Technical Standards and Safety Act
Propane Storage and Handling Regulation

SECTION A: GENERAL INFORMATION (cont'd)

Indicate the year the facility was established. 2011 Indicate the year of any significant modifications, as defined in s.1, O.Reg 211/01, since establishment. 2011

Identify the psig rating and serial number for each fixed propane storage tank on site.

	PSIG	Serial Number
Tank1:	<u>250 PSIG</u>	<u>9J82-11</u>
Tank2:	<u>N/A</u>	<u>N/A</u>
Tank3:	<u>N/A</u>	<u>N/A</u>

Enter capacity of propane in USWG, fixed, portable, and mobile, and provide detailed inventory that includes the number of tank/vessel for each type (fixed, portable, and mobile) and the capacity of each tank/vessel, on a separate document.

Fixed: 2,000 USWG Portable: 481 USWG Mobile: none

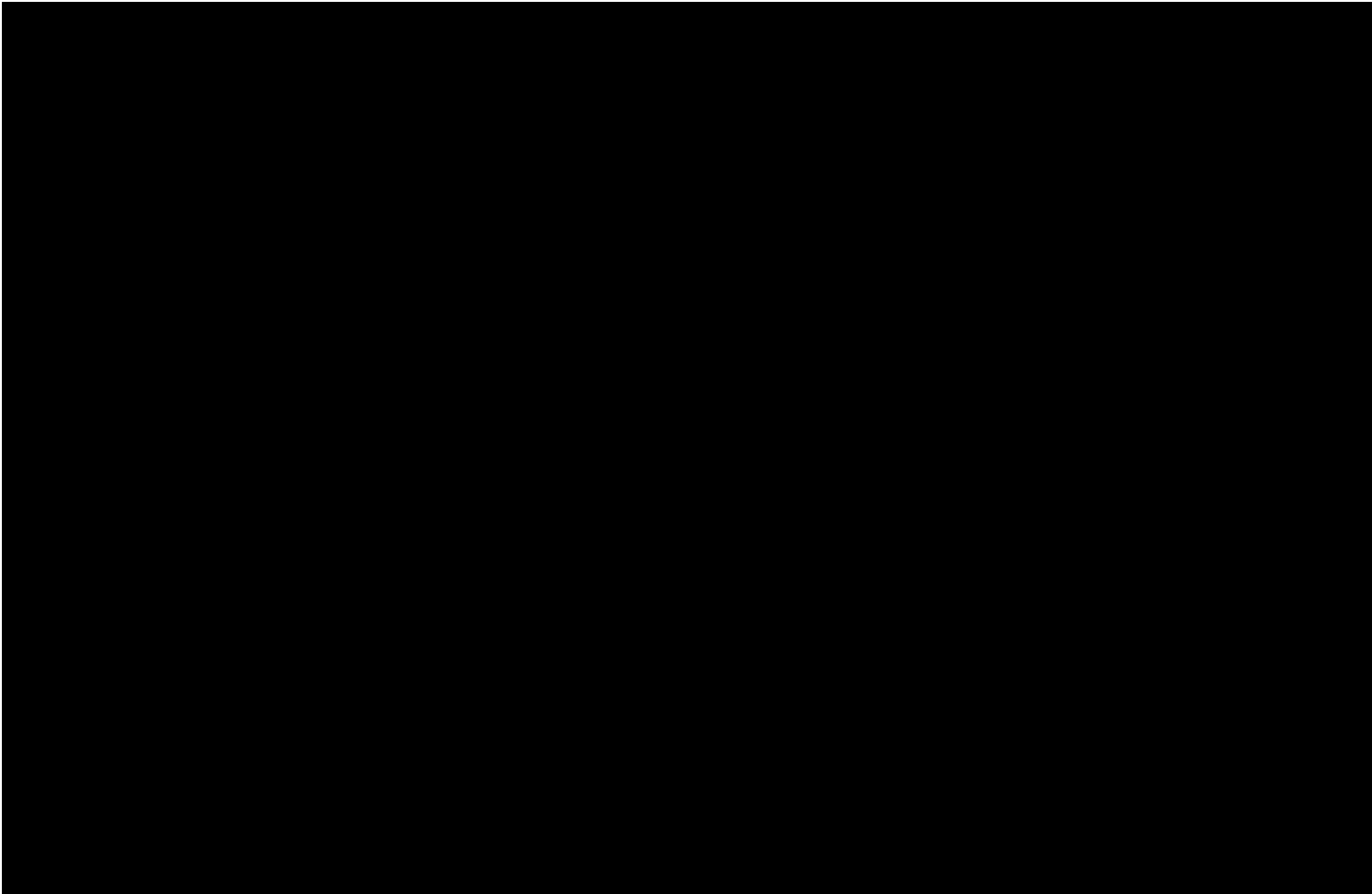

Declaration: I am aware that it is an offence to give false information in this document and I hereby declare that the information I have given here is true and complete.

Name of person completing this form (please print) Gueorgui Ivanov, Physical Plant Impr. Inc., Box 20039, 355 Hespeler Rd, Cambridge	Official Title Engineer
Signature <i>Gueorgui Ivanov</i>	Telephone No. 519.620.0772
	Date (dd-mm-yyyy) 20-08-2011



Technical Standards and Safety Authority
www.tssa.org

14th Floor - Centre Tower
3300 Bloor Street West
Toronto Ontario M8X 2X4
Fax: 416.231.4903
Customer Service: 1.877.682.8772

Level 1 Risk and Safety Management Plan (RSMP)
Technical Standards and Safety Act
Propane Storage and Handling Regulation

SECTION A: GENERAL INFORMATION (cont'd)

Activity Information

Name of Propane Supplier(s) UPI Energy LP		For Office Use - Party No. [REDACTED]	
Street No. 105	Street Name / 911 Number / Address, if applicable Silvercreek Parkway North, Suite 200		
Town / City or Township / Country Guelph		Province Ontario	Postal Code N1H 8M1
Telephone No. 519-821-2667	Fax No. 519-821-4919	Contact Name Dana Wells	
E-mail dwells@upi.on.ca			

Name of Propane Transporter. If same as above, please check box. <input type="checkbox"/>		For Office Use - Party No. <input checked="" type="checkbox"/>	
Primemax Energy Inc.			
Street No. 2558	Street Name / 911 Number / Address, if applicable Cedar Creek Road		
Town / City or Township / Country Ayr		Province ONTARIO	Postal Code N0B 1E0
Telephone No. 519-740-8209	Fax No. 519-740-1015	Contact Name Anthony Hiebert	
E-mail ahiebert@primemaxenergy.com			

Off-site Cylinder and/or Mobile Storage NOT APPLICABLE	Capacity stored off-site, in USWG	For Office Use - Party No.	
Street No. / Street Name / 911 Number / Address, if applicable			
Town / City or Township / Country		Province	Postal Code
Telephone No.	Fax No.	Contact Name	

Note: Customer storage is not considered off-site storage.

Declaration: I am aware that it is an offence to give false information in this document and I hereby declare that the information I have given here is true and complete.

Name of person completing this form (please print) Gueorgui Ivanov, Physical Plant Impr. Inc., Box 20039, 355 Hespeler Rd, Cambridge	Official Title Engineer
Signature 	Telephone No. 519.620.0772
	Date (dd-mm-yyyy) 20-08-2011



Technical
Standards and
Safety Authority
www.tssa.org

14th Floor - Centre Tower
3300 Bloor Street West
Toronto Ontario M8X 2X4
Fax: 416.231.4903
Customer Service: 1.877.682.8772

Level 1 Risk and Safety Management Plan (RSMP)
Technical Standards and Safety Act
Propane Storage and Handling Regulation

SECTION B: EMERGENCY AND PREPAREDNESS RESPONSE PLAN

The licence holder will complete Section B in consultation with the local Fire Services.

Description of the maximum volume, types and storage location of other hazardous materials on site, if any.

Asbestos in pipe insulation-All locations are labeled inside every building

Packed-Waste Oils-Building # 1, 3rd floor

Packed-Welding gases-Building # 27 1st floor

Description of fire and emergency equipment indicated on facility site map.

FIRE EXTINGUISHER:

(1) AT PROPANE FILLER PLANT

(1) AT EACH FORKLIFT

VARIOUS LOCATIONS IN THE PLANT

List of fire protection controls (e.g., fire detection systems, fire notification systems, alarm systems, automatic shut off devices, fusible links, etc.) and describe their function, use and operation.

(Existing facility as of April 2011) Note: this information will be updated when the new filler plant is completed

ISC VALVE IS OPEN AND CLOSED MANUALLY BY A CABLE.

TEMPERATURE-SENSITIVE ELEMENT (FUSIBLE LINK) IS INSTALLED AT THE ISC VALVE. THE ISC VALVE WILL CLOSE AUTOMATICALLY

THROUGH THERMAL ACTUATION. MAIN SWITCH - TURNS OFF THE POWER TO THE PROPANE FACILITY

Maintenance and testing schedule for fire protection controls and devices.

ANNUAL CHECK: FIRE EXTINGUISHER, ISC VALVE, FUSIBLE LINK (PERFORMED BY CERTIFIED TECHNICIAN)

Declaration: I am aware that it is an offence to give false information in this document and I hereby declare that the information I have given here is true and complete.

Name of person completing this form (please print) Gueorgui Ivanov, Physical Plant Impr. Inc., Box 20039, 355 Hespeler Rd, Cambridge		Official Title Engineer
Signature 	Telephone No. 519.620.0772	Date (dd-mm-yyyy) 20-08-2011



Technical Standards and Safety Authority
 345 Carlingview Drive
 Toronto, Ontario M9W 6N9
 Tel: 416.734.3300
 Fax: 416.234.9169
 Customer Service: 1.877.682.8772
 www.tssa.org

Level 1 Risk and Safety Management Plan (RSMP)
Technical Standards and Safety Act
 Propane Storage and Handling Regulation

SECTION B: EMERGENCY AND PREPAREDNESS RESPONSE PLAN (cont'd)

1. Contacts for Emergency Response

1. Facility Contact Personnel - Key Contact		5. Facility 24-Hour Contact Person	
Name Doug van den Hoek	For Office Use - Party No.	Name Dana Wells	For Office Use - Party No.
Official Title Maintenance Manager		Official Title Manager, ERT, Compliance & Fleet Services	
Telephone No. 519-576-5565 x 3030	Fax No. 519-576-1315	Cell No. 519-240-8591	Fax No. 519-821-2618
E-mail dhoek@airboss.ca		E-mail dwells@upi.on.cca	
Role and responsibilities in emergency ERTMember: Activate emergency switch, alert everyone at the facility via the PA sys. to evacuate to mustering point, call 911 & UPI 1-800-396-2667.		Role and responsibilities in emergency ERT (Emergency Response Team) Coordinator	
2. Facility Contact Personnel - Alternate Contact		6. Name of Facility Manager	
Name Theresa Sonder	For Office Use - Party No.	Name Steve Barefoot	For Office Use - Party No.
Official Title EHS Manager AirBoss		Official Title Plant Manager AirBoss	
Telephone No. 519-576-5565, x 3062	Fax No. 519-576-1315	Telephone No. 519-576-5565, x 3032	Fax No. 519-576-1315
E-mail tsonder@airboss.ca		E-mail sbarefoot@airboss.ca (Mr. Steve Barefoot)	
Role and responsibilities in emergency ERTMember: Activate emergency switch, alert everyone at the facility via the PA sys. to evacuate to mustering point, call 911 & UPI 1-800-396-2667.		Role and responsibilities in emergency ERTMember: Activate emergency switch, alert everyone at the facility via the PA sys. to evacuate to mustering point, call 911 & UPI 1-800-396-2667.	
3. Local Fire Services - Key Contact		7. Propane Supplier Key Contact Person	
Name Phil Mellor	For Office Use - Party No.	Name Dana Wells	For Office Use - Party No.
Official Title Fire Prevention Officer	E-mail phil.mellor@kitchener.ca	Official Title Manager, ERT, Compliance & Fleet	E-mail dwells@upi.on.ca
Telephone No. 519-741-2495	Fax No. 519-741-2697	Telephone No. 519-240-8591	Fax No. 519-821-2618
Role and responsibilities in emergency INTERNAL AND EXTERNAL EVACUATION, ESTABLISH SAFETY ZONES, FIRE SUPPRESSION, COOL PROPANE TANK		Role and responsibilities in emergency ERT (Emergency Response Team) Coordinator See attached Emergency Preparedness Plan	
Fire Services Address 270 Strasburg Rd., Kitchener, ON N2E 3M6		Propane Supplier Address 105 Silvercreek Parkway N, Suite 200, Guelph ON N1H 8M1	
4. Local Fire Services - Alternate Contact		8. Municipal Contact	
Name Tom Ruggle	For Office Use - Party No.	Name Michele Brubacher (interim: Tim Seyler)	For Office Use - Party No.
Official Title Chief Fire Prevention Officer	E-mail tom.ruggle@kitchener.ca	Official Title Planning and Development	
Telephone No. 519-741-2495	Fax No. 519-741-2697	Telephone No. 519-741-2317	Fax No. 519-741-2624
Role and responsibilities in emergency INTERNAL AND EXTERNAL EVACUATION, ESTABLISH SAFETY ZONES, FIRE SUPRESION, COOL PROPANE TANK		E-mail Michele.Brubacher@kitchener.ca (interim: tim.seyler@kitchener.ca)	
Fire Services Address 270 Strasburg Rd., Kitchener, ON N2E 3M6		Municipality Name and Address City of Kitchener, 200 King St W, PO Box 1118 ON N2G 4G7	

Declaration: I am aware that it is an offence to give false information in this document and I hereby declare that the information I have given here is true and complete.

Name of person completing this form (please print) <i>JUDY HE. MILEY COMPANY LIMITED</i>	Official Title
Signature <i>J. Miley</i>	Telephone No. <i>416-298-9563</i>
	Date (dd-mmm-yyyy) <i>16-FEB-2017</i>



Technical Standards and Safety Authority
www.tssa.org

14th Floor - Centre Tower
3300 Bloor Street West
Toronto Ontario M8X 2X4
Fax: 416.231.4903
Customer Service: 1.877.682.8772

Level 1 Risk and Safety Management Plan (RSMP)
Technical Standards and Safety Act
Propane Storage and Handling Regulation

SECTION B: EMERGENCY AND PREPAREDNESS RESPONSE PLAN (cont'd)

2. Additional Safety Measures

Describe any other measures in place at the facility that exceed the minimum Code and Standards requirements.

- Annual maintenance: a licensed contractor performs annual inspection of filling system and mechanical devices according to the UPI Energy

LP Propane Dispenser Inspection Report

First Aid/CPR training (Mar.2011, Mar.2010, Apr.2010 every 3 years) All Cell Leaders and Business Unit Managers (+Others Misc.)

Transport Dangerous Goods (All Shipper/Receivers, Salvage every 3 yrs.)

Fire Suppressing Procedure OHS P.P.20.57

WHMIS/MSDS OHS P.P.20.31, OHS P.P.20.32 (Orientation)

Globally Harmonized System OHS.P.P.20.31 (In Process)

Emergency Preparedness and Response OHS 12.1 (Orientation)

Code 99 (Orientation)

Propane Emergency Plan OHS.P.P.20.47

Propane Safety OHS P.P.20.36

Declaration: I am aware that it is an offence to give false information in this document and I hereby declare that the information I have given here is true and complete.

Name of person completing this form (please print) Gueorgui Ivanov, Physical Plant Impr. Inc., Box 20039, 355 Hespeler Rd, Cambridge		Official Title Engineer	
Signature 		Telephone No. 519.620.0772	Date (dd-mm-yyyy) 20-08-2011



Technical Standards and Safety Authority
 345 Carlingview Drive
 Toronto, Ontario M9W 6N9
 Tel: 416.734.3300
 Fax: 416.234.9169
 Customer Service: 1.877.682.8772
 www.tssa.org

Level 1 Risk and Safety Management Plan (RSMP)
Technical Standards and Safety Act
 Propane Storage and Handling Regulation

SECTION B: EMERGENCY AND PREPAREDNESS RESPONSE PLAN (cont'd)

3. Record of Emergency Training Provided - For most recent 12-month period.

Training on Emergency Response Plan and Procedures provided to facility key contacts.

Training Date (dd-mmm-yyyy) New Hire Orientation	Print Name of Training Provider: AirBoss - New Hire Orientation
	Print Name of Instructor: Theresa Sonder
Training Date (dd-mmm-yyyy) 26-JAN-2016	Print Name of Training Provider: AirBoss
	Print Name of Instructor: Theresa Sonder
Training Date (dd-mmm-yyyy) 26-JAN-2016	Print Name of Training Provider:
	Print Name of Instructor:

Training on the facility's Emergency Management Procedures provided to staff.

Training Date (dd-mmm-yyyy) New Hire Orientation	Print Name of Training Provider: AirBoss
	Print Name of Instructor: Theresa Sonder
Training Date (dd-mmm-yyyy) 26-JAN-2016	Print Name of Training Provider: AirBoss - Propane Emergency Plan (OHS P.P.20.47)
	Print Name of Instructor: Theresa Sonder
Training Date (dd-mmm-yyyy) 26-JAN-2016	Print Name of Training Provider: AirBoss - Fire Suppression Procedures (OHS P.P.20.57)
	Print Name of Instructor: Theresa Sonder

On-site specific training provided to certificate holders / persons with Records of Training.

Training Date (dd-mmm-yyyy) 26-JAN-2016	Print Name of Training Provider: AirBoss - Propane Emergency Plan (OHS P.P.20.47)
	Print Name of Instructor: Theresa Sonder
Training Date (dd-mmm-yyyy) 26-JAN-2016	Print Name of Training Provider: AirBoss - Fire Suppression Procedures (OHS P.P.20.57)
	Print Name of Instructor: Theresa Sonder
Training Date (dd-mmm-yyyy)	Print Name of Training Provider:
	Print Name of Instructor:

Declaration: I am aware that it is an offence to give false information in this document and I hereby declare that the information I have given here is true and complete.

Name of person completing this form (please print) <i>JUDY UE, MILEY COMPANY LIMITED</i>	Official Title	
Signature <i>Judy Ue</i>	Telephone No. <i>416-298-9563</i>	Date (dd-mmm-yyyy) <i>10-FEB-2017</i>



Technical Standards and Safety Authority
 345 Carlingview Drive
 Toronto, Ontario M9W 6N9
 Tel: 416.734.3300
 Fax: 416.234.9169
 Customer Service: 1.877.682.8772
 www.tssa.org

Level 1 Risk and Safety Management Plan (RSMP)
Technical Standards and Safety Act
 Propane Storage and Handling Regulation

SECTION B: EMERGENCY AND PREPAREDNESS RESPONSE PLAN (cont'd)

4. Emergency Training Plan for Coming Year

Training on Emergency Response Plan and Procedures provided to facility key contacts.

Target Date (dd-mmm-yyyy) 28-FEB-2017	Print Name of Training Provider: AirBoss
	Print Name of Instructor: Theresa Sonder
Target Date (dd-mmm-yyyy)	Print Name of Training Provider:
	Print Name of Instructor:
Target Date (dd-mmm-yyyy)	Print Name of Training Provider:
	Print Name of Instructor:

Training on the facility's Emergency Management Procedures provided to staff.

Target Date (dd-mmm-yyyy) 28-FEB-2017	Print Name of Training Provider: AirBoss
	Print Name of Instructor: Theresa Sonder
Target Date (dd-mmm-yyyy)	Print Name of Training Provider:
	Print Name of Instructor:
Target Date (dd-mmm-yyyy)	Print Name of Training Provider:
	Print Name of Instructor:

On-site specific training provided to certificate holders / persons with Records of Training.

Target Date (dd-mmm-yyyy) 28-FEB-2017	Print Name of Training Provider: AirBoss
	Print Name of Instructor: Theresa Sonder
Target Date (dd-mmm-yyyy)	Print Name of Training Provider:
	Print Name of Instructor:
Target Date (dd-mmm-yyyy)	Print Name of Training Provider:
	Print Name of Instructor:

Declaration: I am aware that it is an offence to give false information in this document and I hereby declare that the information I have given here is true and complete.

Name of person completing this form (please print) JUDY UE, MILEY COMPANY LIMITED	Official Title
Signature <i>Judy Ue</i>	Telephone No. 416-298-9563
	Date (dd-mmm-yyyy) 10-FEB-2017



Technical Standards and Safety Authority
www.tssa.org

14th Floor - Centre Tower
3300 Bloor Street West
Toronto Ontario M8X 2X4
Fax: 416.231.4078
Customer Service: 1.877.682.8772

**Application for Renewal of
Level 1 Propane Licence
Technical Standards and Safety Act
Propane Storage and Handling Regulation**

EMERGENCY AND PREPAREDNESS RESPONSE PLAN (cont'd)

The licence holder will complete the Emergency and Preparedness Response Plan in consultation with the local Fire Services.
Emergency Response Communications Plan

Warnings and Actions

Describe who gives warnings to whom, and how and when the warning will be given (including public notification as appropriate).
All AirBoss maintenance employees are trained to be a propane incident Emergency Response Team (ERT) member. Upon detection of ignited or unignited propane leak that is not contained they will verbally notify personnel nearby to evacuate safely to the mustering point and ensure that all directions are followed. The following internal evacuation script will be made "Code 99 - We have a propane emergency. Evacuate to evacuation assembly area."
Maintenance will call 911 and UPI Energy LP emergency response at 1-800-396-2667.

Describe what action is to be taken and by whom when a warning is issued (including details of a meeting place in a safe identified area and activating the evacuation plan, if necessary).
See above. Mustering Point #1 is beside Kaufmann's (across from shipping/receiving). Mustering Point #2 is along the yellow guardrail in the main employee parking lot.

Communication with Emergency Response Authorities

Describe when and how the licence holder will give early warning to emergency response authorities (including a process to ensure that a call is placed to 911).
See above. Upon detection of ignited or unignited propane leak that is not contained, the ERT member will call 911 and UPI Energy LP at 1-800-396-2667.

Describe provisions for fire department entry when there are no operations or staffing at the propane site.
The propane facility is part of a manufacturing plant, with gated entrance at all times. Video surveillance of the propane station will be maintained. Once 911 services are on-site the North Gate entrance will open to allow access. The propane fill equipment is housed in a metal cabinet, which is closed and locked when not in use. This lock can be broken open for fire department access. The ISC valve on the propane tank is connected to a lever via fusible link. When in the opened position, the lever prevents cabinet closure. Therefore, the lever and the ISC valve will be closed, when the cabinet is closed.

Describe how the licence holder will ensure continual flow of updated information to authorities.
UPI Energy LP Emergency Response (ERT) Coordinator is available 24 hr/day, 365 days/year at 1-800-396-2667. When the ERT member placed the call to alert the ERT Coordinator, the ERT Coordinator will assign a Qualified Local Person to be the main liaison to the local authorities responsible for the external emergency plan and will provide an estimated time for a Qualified Local Person to respond to the site.

How long will it take the facility liaison person to respond to the site.
30 to 60 minutes

You are required by law to notify TSSA of any change of information contained in the Risk and Safety Management Plan within 15 days.

Declaration: I am aware that it is an offence to give false information in this document and I hereby declare that the information I have given here is true and complete.

Print name of person completing this form. <i>JUDY LIE, MILEY COMPANY LIMITED</i>		Official Title	
Signature <i>[Signature]</i>		Telephone No. <i>416 298 9563</i>	Date (dd-mmm-yyyy) <i>10-FEB-2017</i>



Technical Standards and Safety Authority
www.tssa.org

14th Floor - Centre Tower
3300 Bloor Street West
Toronto Ontario M8X 2X4
Fax: 416.231.4903
Customer Service: 1.877.682.8772

Level 1 Risk and Safety Management Plan (RSMP)
Technical Standards and Safety Act
Propane Storage and Handling Regulation

SECTION B: EMERGENCY AND PREPAREDNESS RESPONSE PLAN (cont'd)

The licence holder will complete Section B in consultation with the local Fire Services.

6. Building and Site Security and Procedures

- | | Yes | No |
|---------------------------------------------------------------------------------------------------------------------------------------------------------------------------------------|-------------------------------------|--------------------------|
| 1. Does the propane location have controlled access to limit unnecessary risk and entry (lock out procedures)? | <input checked="" type="checkbox"/> | <input type="checkbox"/> |
| 2. Is there adequate night lighting at the site? | <input checked="" type="checkbox"/> | <input type="checkbox"/> |
| 3. Are procedures in place that ensure access routes, aisles, storage area, filling areas and the grounds are kept clear from unwanted materials? | <input checked="" type="checkbox"/> | <input type="checkbox"/> |
| 4. Are there procedures that capture and record the daily inspection of hoses and inspection requirements for filling systems and mechanical devices used in the transfer of propane? | <input checked="" type="checkbox"/> | <input type="checkbox"/> |
| 5. Does the facility have procedures that include a process to isolate and purge any overfilled propane cylinders? | <input checked="" type="checkbox"/> | <input type="checkbox"/> |
| 6. Are weighing systems validated for accuracy? | <input checked="" type="checkbox"/> | <input type="checkbox"/> |
| 7. Are storage areas clearly marked with the vessels' capacity status (i.e., filled, empty, purged and other hazardous materials)? | <input checked="" type="checkbox"/> | <input type="checkbox"/> |
| 8. Are quality assurance procedures in place to ensure that all valves are closed after the propane cylinders are filled?(e.g., QCC valves) | <input checked="" type="checkbox"/> | <input type="checkbox"/> |
| 9. Is the schedule of maintenance and testing activities retained on site? | <input checked="" type="checkbox"/> | <input type="checkbox"/> |

7. Water Supply

The propane licence holder should work with the local fire department to determine water supply capabilities that are available based on the propane facility's location.

- | | Yes | No |
|-------------------------------------------------------------------------------------------------------------------------------------------------------|-------------------------------------|--------------------------|
| 1. Is a pressurized water system available at the propane facility site? | <input checked="" type="checkbox"/> | <input type="checkbox"/> |
| 2. Can the municipal fire department pump 375 GPM (1420 LPM) of water at this location? | <input checked="" type="checkbox"/> | <input type="checkbox"/> |
| 3. What is the unobstructed distance to the closest water supply that could be used for firefighting activities? (distance in metres only) | 113 _____ | |
| 4. What is the unobstructed distance to the closest approved water supply with year round access if there are no hydrants? (distance in metres only) | N/A _____ | |

Declaration: I am aware that it is an offence to give false information in this document and I hereby declare that the information I have given here is true and complete.

Name of person completing this form (please print) Gueorgui Ivanov, Physical Plant Impr. Inc., Box 20039, 355 Hespeler Rd, Cambridge		Official Title Engineer	
Signature 		Telephone No. 519.620.0772	Date (dd-mm-yyyy) 20-08-2011



Technical Standards and Safety Authority
www.tssa.org

14th Floor - Centre Tower
3300 Bloor Street West
Toronto Ontario M8X 2X4
Fax: 416.231.4903
Customer Service: 1.877.682.8772

Level 1 Risk and Safety Management Plan (RSMP)
Technical Standards and Safety Act
Propane Storage and Handling Regulation

SECTION B: EMERGENCY AND PREPAREDNESS RESPONSE PLAN (cont'd)

The licence holder will complete Section B in consultation with the local Fire Services.

8. Licence holder and local Fire Services Review

To be completed by the Local Fire Services

Has the local fire service had an opportunity to review the Emergency Response and Preparedness Plan?

Yes	No
<input checked="" type="checkbox"/>	<input type="checkbox"/>

If not, please explain (e.g., no fire services).

Fire services comments, if any:

Residential receptors are located within the blast radius identified in the plan approximately 174m from the storage tank. It is the opinion of this Department that the owner/operator should employ/install engineered risk mitigation procedures and equipment at this site to lower the risk to the present and future residential receptors to an acceptable level.

To be completed by the Licence Holder

In response to the above comments, the following action(s) is required: *THE ACTUAL DISTANCE IS 226M. THE RESIDENCES ARE SHIELDED ON 3 SIDES BY OUR BRICK AND CONCRETE STRUCTURE 4 STORIES 21.4M HT - 34.1M WIDE. THERE IS ANOTHER 3 STOREY BLDG ALONG STANGE ST. 15M HT.*

The licence holder will respond to the Local Fire Services comments by: *14-10-11* (dd-mm-yyyy)

LOCAL FIRE SERVICES

The undersigned has reviewed Section B of the Risk and Safety Management Plan Fire Services.

Print name	Signature	Date (dd-mm-yyyy)
Local Fire Services Name Phil Mellor, Assistant Chief Fire Prevention Officer	<i>[Signature]</i>	October 13, 2011

Declaration: I am aware that it is an offence to give false information in this document and I hereby declare that the information I have given here is true and complete.

Name of person completing this form (please print) Gueorgui Ivanov, Physical Plant Impr. Inc., Box 20039, 355 Hespeler Rd., Cambridge	Official Title Engineer	Date (dd-mm-yyyy) 20-08-2011
Signature <i>[Signature]</i>	Telephone No. 519.620.0772	



Technical Standards and Safety Authority
www.tssa.org

14th Floor - Centre Tower
3300 Bloor Street West
Toronto Ontario M8X 2X4
Fax: 416.231.4903
Customer Service: 1.877.682.8772

Level 1 Risk and Safety Management Plan (RSMP)
Technical Standards and Safety Act
Propane Storage and Handling Regulation

SECTION C: SUBMISSIONS

Applicant must include a Facility Site Plan and Map of Surrounding Area

Facility Site Plan.

The licence holder will submit a copy of the original facility site plan updated with the following information:

1. The storage location of fixed, portable, and mobile vessels.
2. The maximum volume, types and storage location of hazardous materials.
3. Location of permanent structures on site.
4. Access and egress points and location of barriers.
5. Location of fire and emergency equipment (e.g., sprinkler systems, extinguishers, suppression systems) on site and location of fire hydrant or water supply where available.
6. Location of emergency shut off/shut down switches/valves.

Map of Surrounding Area.

The licence holder will submit a scaled aerial map of the surrounding area showing the following information:

7. The capacity and placement of the single largest propane storage vessel, including its setback from the front, rear and side property lines.
8. GPS co-ordinates of the single largest vessel.
9. Visual indication of the single largest fixed vessel and a circle made using the distance in Table 1 as the radius from the single largest fixed vessel.
10. Clear indication of the municipality or municipalities present within the circle.
11. Visual indication of property line information.
12. The location and name of roads within or abutting the site.
13. Key note to the drawing indicating the facility's municipal address, municipal lot number(s) and concession lines as applicable, and the date the map was prepared.
14. Address and contact information for each municipality (municipal clerk or secretary-treasurers of planning board). (Refer to page 5.)
15. Complete "Required Mapping Information from Updated Site Plan" in table below.

Required Mapping Information from Updated Site Plan

Date Map Prepared (dd-mm-yyyy) 20-07-2011	Capacity of single largest propane storage vessel (USWG) 2,000 USWG
Tank setback coordinates. Indicate placement on the map.	
Front: 287 M	Right side property line: 155.7 M
Rear: 112 M	Left side property line: 51.2 M
GPS coordinates of single largest vessel: 43°27'3.75"N 80°30'40.30"W	

Declaration: I am aware that it is an offence to give false information in this document and I hereby declare that the information I have given here is true and complete.

Name of person completing this form (please print) Gueorgui Ivanov, Physical Plant Impr. Inc., Box 20039, 355 Hespeler Rd, Cambridge	Official Title Engineer
Signature 	Telephone No. 519.620.0772
	Date (dd-mm-yyyy) 20-08-2011



Technical Standards and Safety Authority
www.tssa.org

14th Floor - Centre Tower
3300 Bloor Street West
Toronto Ontario M8X 2X4
Fax: 416.231.4903
Customer Service: 1.877.682.8772

Level 1 Risk and Safety Management Plan (RSMP)
Technical Standards and Safety Act
Propane Storage and Handling Regulation

SECTION C: SUBMISSIONS (cont'd)

Applicant must include a Facility Site Plan and Map of Surrounding Area

Table 1: Distance Table

Water Capacity (litres)	Nominal Water Capacity (USWG)	Distance to 1 psi overpressure (m)
1,890	500	155
3,780	1,000	195
4,920	1,300	213
6,620	1,750	235
7,130	1,885	241
7,560	2,000	246
18,900	5,000	333

Formula: $D = 16.94 \times (1.524 \times C)^{1/3}$
 D = Distance to overpressure of 1 psi (meters)
 C = Tank Total Capacity in USWG

Parameters: Density of Propane is 0.5033 kg per litre @ 15 C
 Assume all vessels are 80% full
 1 gallon [US, liquid] = 0.003785411784 cubic meter
 1 cubic metre = 264.17 USWG

Hazard Distance Chart (EPA-TNT model)

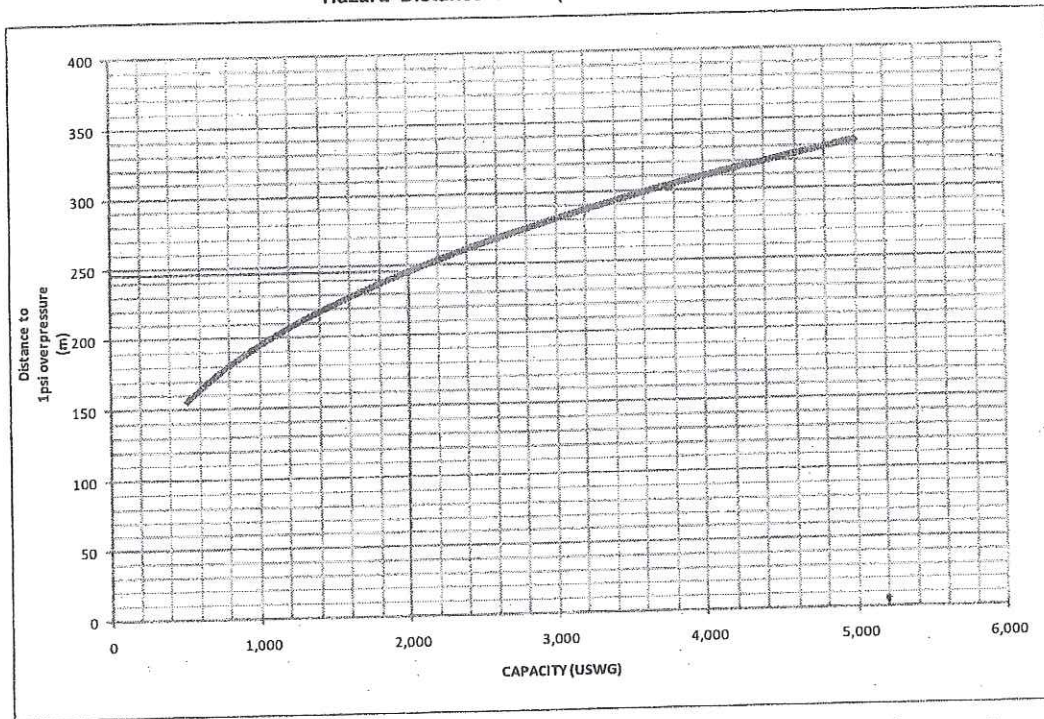

Declaration: I am aware that it is an offence to give false information in this document and I hereby declare that the information I have given here is true and complete.

Name of person completing this form (please print) Gueorgui Ivanov, Physical Plant Impr. Inc., Box 20039, 355 Hespeler Rd, Cambridge		Official Title Engineer
Signature 	Telephone No. 519.620.0772	Date (dd-mm-yyyy) 20-08-2011



Technical Standards and Safety Authority
www.tssa.org

14th Floor - Centre Tower
3300 Bloor Street West
Toronto Ontario M8X 2X4
Fax: 416.231.4903
Customer Service: 1.877.682.8772

Level 1 Risk and Safety Management Plan (RSMP)
Technical Standards and Safety Act
Propane Storage and Handling Regulation

SECTION C: SUBMISSIONS (cont'd)

Applicant must include a Facility Site Plan and Map of Surrounding Area

As an accompaniment to the Map of Surrounding Area, provide the following information about buildings and features present within the circle in Table 2.

Table 2: Buildings and Features

Buildings and Features Present within the Circle on the Map of the Surrounding Area AND Name and Address of Closest Building or Feature	* Number of Buildings and Features (mark with an "X")				Distance from Tank to Closest Building or Feature
	0	1	2-10	11+	
Industrial buildings or parks or golf courses Name: Kumfort Zone Address: 137 Glasgow City: Kitchener Province ONTARIO Postal Code N2G 4X8		X			106 m
Residential building units specifically permanent single family dwellings, condominiums, and apartments. Name: [REDACTED] Address: [REDACTED] City: [REDACTED]				X	174 m
Commercial building units specifically retail, restaurants, entertainment, theatres, and sporting complexes. Name: Warren Greenhouses Address: 115 Strange Street City: Kitchener Province ONTARIO Postal Code N2G 1R4			X		143 m
Commercial building units – continuous occupancy specifically hotels, campgrounds, and resorts. Name: _____ Address: _____ City: _____ Province ONTARIO Postal Code _____	X				_____ m
Sensitive institutions specifically hospitals, schools and day cares, nursing and retirement homes, mental health institutions, and prisons. Name: _____ Address: _____ City: _____ Province _____ Postal Code _____	X				_____ m
Emergency responders specifically fire stations, ambulance stations, and police stations. Name: Fire Station #5 Address: 1700 Queens Blvd. City: Kitchener Province ONTARIO Postal Code _____	X				_____ m

* For multi-unit buildings, count each unit as "1".

Declaration: I am aware that it is an offence to give false information in this document and I hereby declare that the information I have given here is true and complete.

Name of person completing this form (please print) Gueorgui Ivanov, Physical Plant Impr. Inc., Box 20039, 355 Hespeler Rd, Cambridge	Official Title Engineer
Signature 	Telephone No. 519.620.0772
	Date (dd-mm-yyyy) 20-08-2011



Technical Standards and Safety Authority
www.tssa.org

14th Floor - Centre Tower
3300 Bloor Street West
Toronto Ontario M8X 2X4
Fax: 416.231.4903
Customer Service: 1.877.682.8772

Level 1 Risk and Safety Management Plan (RSMP)
Technical Standards and Safety Act
Propane Storage and Handling Regulation

SECTION C: SUBMISSIONS (cont'd)

Applicant must include a Facility Site Plan and Map of Surrounding Area

Portable Storage Additional Information Sheet

Cylinder Size	Capacity in USWG	Quantity	Total Volume in USWG
# 420	123.9		
# 100	29.5		
# 40	11.75		
# 33.3	9.62	50	481
# 30	8.8		
# 20	5.8		
# 10	2.9		
# 5	1.5		
Total Cylinder Capacity 481 USWG			

Tanks Stored On-site Not Connected for Use

Tank Size In USWG	Quantity	Total Volume in USWG
Total Tank Capacity		

Total Cylinder Capacity	481 USWG
Total Tank Capacity	
Total Portable Capacity	481 USWG

Declaration: I am aware that it is an offence to give false information in this document and I hereby declare that the information I have given here is true and complete.

Name of person completing this form (please print) Gueorgui Ivanov, Physical Plant Impr. Inc., Box 20039, 355 Hespeler Rd, Cambridge		Official Title Engineer	
Signature 		Telephone No. 519.620.0772	Date (dd-mm-yyyy) 20-08-2011

8 7 6 5 4 3 2 1



DIMENSIONS SHOWN INCLUDE 1/60 (3σ) ADJUSTMENT FOR RESOLUTION OF THE AERIAL IMAGE

REV.	DATE	DESCRIPTION
2		
1		

Lower-tier municipality:
 City of Kitchener
 200 King St. W., 6th floor
 KITCHENER, ON N2G 4G7
 Attn: Michele Brubacher
 Planning Division
 Community Services
 Tel: 519-741-2345

Upper-tier municipality:
 Region of Waterloo
 150 Frederick St.
 P.O. Box 9051 Station 'C'
 Kitchener, ON N2G 4J3
 Planning, Housing &
 Community Services
 Tel: 519-575-4533

Airboss Rubber Compounding
 101 Glasgow Street
 Kitchener, ON N2G 4X8

PROPANE LICENCE
 TSSA # 0076647669
 PROPANE FACILITY:
 -STORAGE TANK:
 2,000 USWG
 -CYLINDER REFILL
 -STORAGE CAGES

Propane Tank GPS
 Coordinates:
 Latitude: 43°27'3.90"N
 Longitude: 80°30'42.84"W

HAZARD DISTANCE: RADIUS=246 m
 PERMANENT STRUCTURES WITHIN HD
 EXTERNAL EVACUATION

Public Receptors within HD
 (Approximate Quantity)
 Residences: 5
 Schools: 0
 Hospitals: 0
 Industrial / Commercial / Office Buildings: 10
 Parks and Recreation Areas: 0
 AirBoss Facility: 20

- BUILDINGS AND FEATURES
- (R1) KUMFORT ZONE
 - (R2) RESIDENCE (NEAREST)
 - (R3) WARREN GREENHOUSES



CLIENT		UPI ENERGY LP	
TITLE		AREA MAP	
DR. BY: GI	DATE: July 2011	DR. BY: GEC	DATE: -
CHECKED: GEC	DATE: -	DR. NUMBER: 8.1	REV

Emergency: 911
 UPI Energy LP Emergency
 Response Coordinator:
 1-800-396-2667

July 2011
 Ministry of Natural Resources
 Queen's Printer for Ontario

8 7 6 5 4 3 2 1

AIRBOSS RUBBER COMPOUNDING

PROPERTY LAYOUT

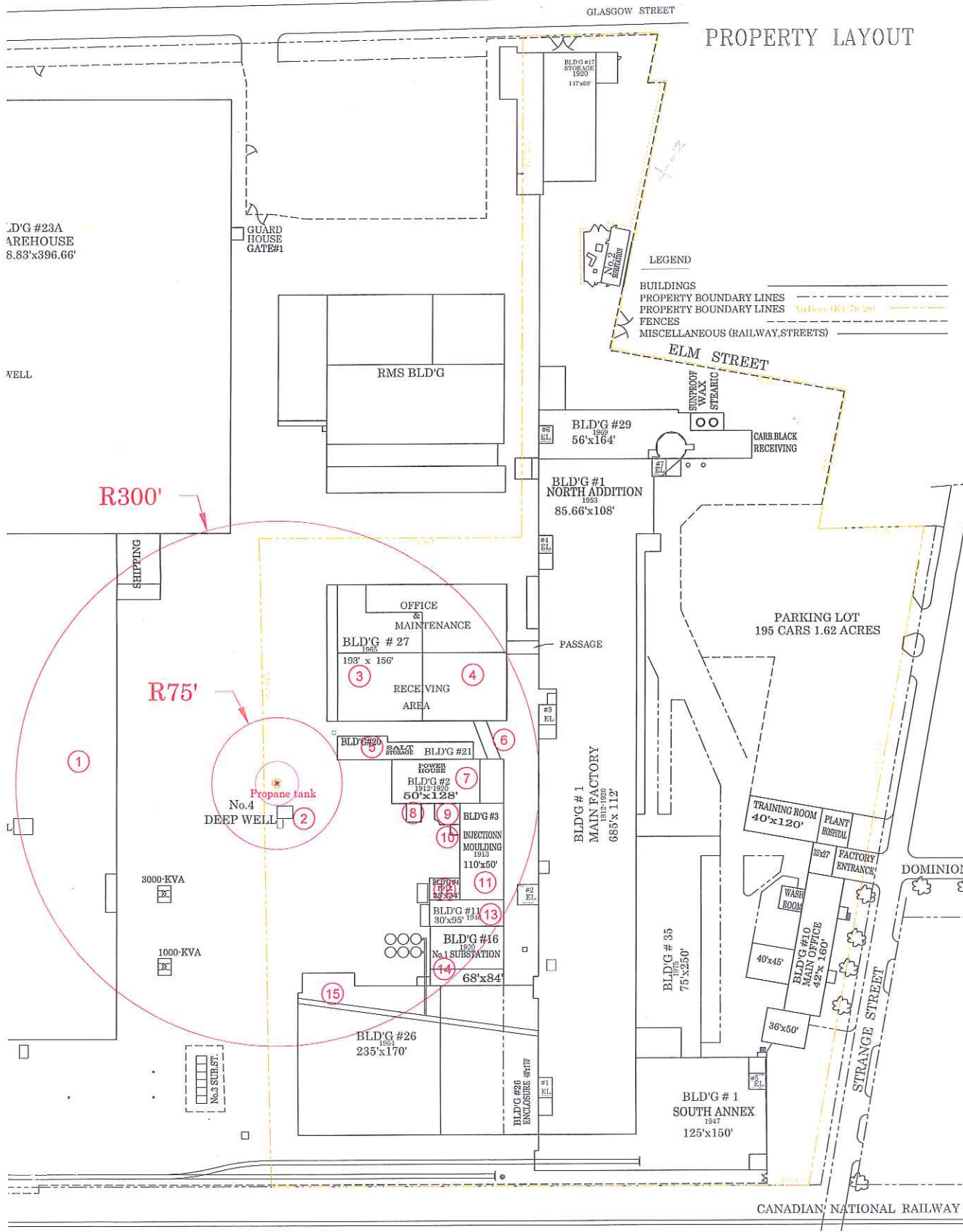

LD'G #23A
AREHOUSE
8.83'x396.66'

WELL

R300'

R75'

Propane tank
No. 4
DEEP WELL

GLASGOW STREET

PROPERTY LAYOUT

LEGEND

- BUILDINGS
- PROPERTY BOUNDARY LINES
- PROPERTY BOUNDARY LINES
- FENCES
- MISCELLANEOUS (RAILWAY, STREETS)

ELM STREET

BLD'G #29
1953
56'x164'

BLD'G #1
NORTH ADDITION
1953
85.66'x108'

RMS BLD'G

OFFICE & MAINTENANCE
BLD'G # 27
1956
193' x 156'

BLD'G #20
1956
50'x126'

BLD'G #2
1912-1950
50'x126'

BLD'G #3
1913
110'x50'

BLD'G #11
1914
30'x95'

BLD'G #16
1930
68'x84'

BLD'G #26
1914
235'x170'

BLD'G # 1
MAIN FACTORY
1912-1920
685' x 112'

PARKING LOT
195 CARS 1.62 ACRES

TRAINING ROOM
40'x120'

PLANT
ENTRANCE

WASH ROOM
40'x45'

BLD'G #10
MAIN OFFICE
42'x 160'

36'x50'

BLD'G # 35
75'x250'

BLD'G # 1
SOUTH ANNEX
1947
125'x150'

DOMINION

STRANGE STREET

CANADIAN NATIONAL RAILWAY